

MODEL 6704 INSTALLATION KIT (Pre 2007) FOR JOHN DEERE 6000 SERIES SELF-PROPELLED FORAGE HARVESTERS

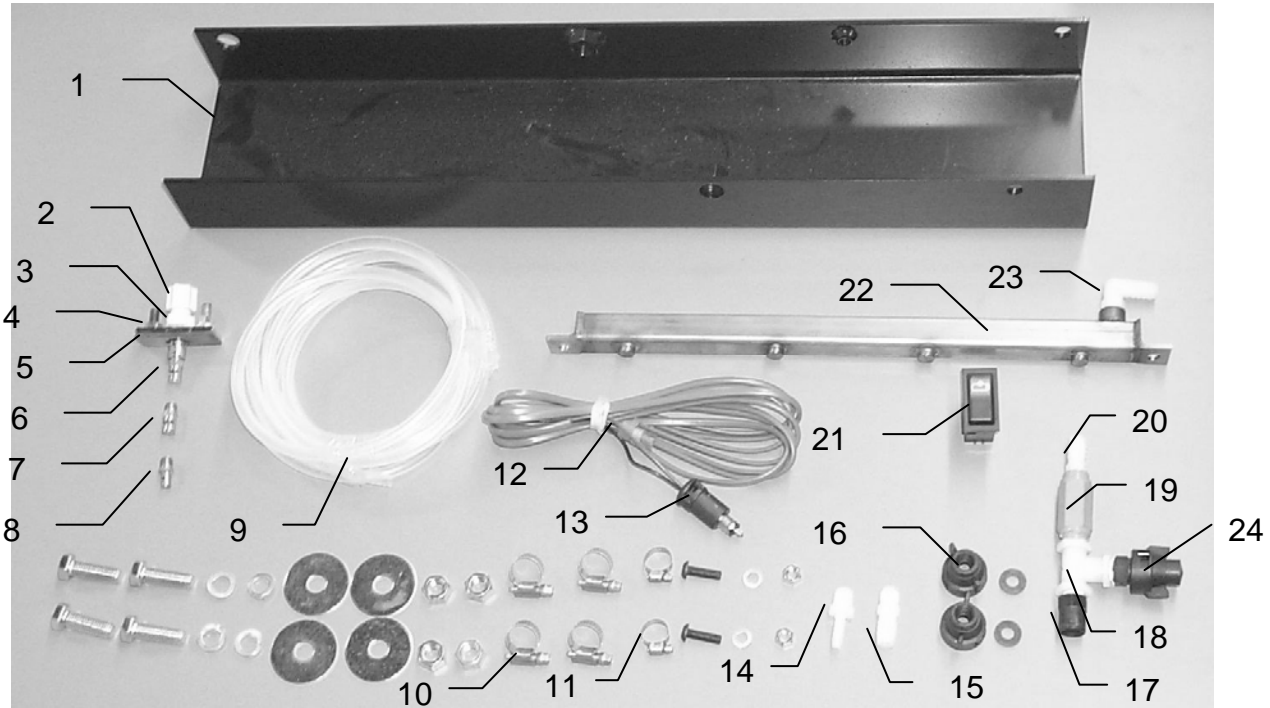

<u>Ref</u>	<u>Description</u>	<u>Part #</u>	<u>Qty</u>	<u>Ref</u>	<u>Description</u>	<u>Part #</u>	<u>Qty</u>
1	Fender support	001-6705F	1	13	Plug	006-6763	1
2	Jaco nut	003-JN14	1	14	Straight fitting	003-A1414	1
3	Jaco straight	003-JA1418	1	15	Straight fitting	003-A1412	1
4	Nozzle holder	001-6712A	1	16	Female disconnect	004-1207H	2
5	Nozzle base	001-6712B	1	17	Quick connect	004-4710	2
6	Tip	004-K2-SS	1	18	Tee	003-TT14	1
7	Tip	004-K4-SS	1	19	Check valve	002-4564F	1
8	Tip	004-K1-SS	1	20	Straight fitting	003-A1412	1
9	1/4" Hose	002-9006	15ft	21	Switch	006-6762	1
10	Hose clamp	003-9003	4	22	Chute lube bar	001-6711	1
11	Hose clamp	003-9002	2	23	Elbow fitting	003-EL1412	1
12	Power lead	006-4580	1	24	Shut-off cap	004-1207F	1

***Purchase common hardware locally**