

# PARTS BREAKDOWN FOR STAR WHEEL SENSOR

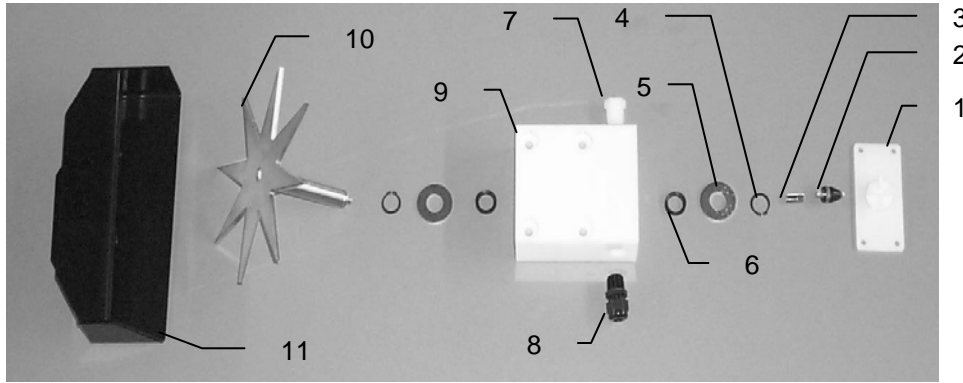

| <u>Ref</u> | <u>Description</u> | <u>Part#</u> | <u>Qty</u> | <u>Ref</u> | <u>Description</u>         | <u>Part#</u> | <u>Qty</u> |
|------------|--------------------|--------------|------------|------------|----------------------------|--------------|------------|
| 1.         | Block cover        | 006-4641B    | 2          | 9.         | Star wheel block           | 006-4641A    | 2          |
| 2.         | Electronic swivel  | 006-4642A    | 2          | 10.        | Star wheel sensor          | 030-4641C    | 2          |
| 3.         | Swivel insert      | w/ Ref # 10  | 2          | 11.        | Twine guard-left           | 001-4645     | 1          |
| 4.         | Snap ring          |              | 4          |            | Twine guard-right (prox)   | 001-4644     | 1          |
| 5.         | Washer             |              | 4          |            | Twine guard-left for Agco  | 001-4645H    | 1          |
| 6.         | Dust seal          |              | 4          |            | Twine guard-Right for Agco | 001-4644H    | 1          |
| 7.         | Plug fitting       | 003-F38      | 2          | 1-10       | Star wheel assembly        | 030-4641     | 2          |
| 8.         | Wiring grommet     | 008-0821A    | 2          | 12.        | Spacer plate for Agco      | 001-6707E    | 2          |

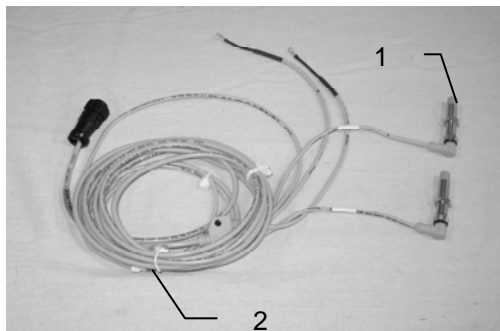

| <u>Ref</u> | <u>Description</u>             | <u>Part#</u> | <u>Qty</u> |
|------------|--------------------------------|--------------|------------|
| 1          | Bale rate sensor               | 006-7303S    | 2          |
| 2          | Moisture and bale rate harness | 006-7303H    | 1          |

