

OWNER'S MANUAL

Model 445-M
25 Gallon (100 Litre)
Automatic Preservative Applicator



P.O. Box 63 • 2821 Harvey Street • Hudson, WI 54016
800-635-7468 • www.harvesttec.com

#010-0445M

REVISED 1-08

HARVEST TEC 445 TABLE OF CONTENTS

	<u>PAGE</u>
INSTALLATION KIT REFERENCE CHART	3
TOOLS NEEDED	3
INSTALLATION OF APPLICATOR	4-15
1. INSTALLATION OF MOUNTING BRACKETS AND TANK	4
2. INSTALLATION OF TANK, REACH RODS AND HOSE MANIFOLD	5
3. INSTALLATION OF PUMP PLATE	6
4. PLACEMENT OF SPRAY NOZZLE ASSEMBLY	7-10
5. INSTALLATION OF PLUMBING	11-12
6. INSTALLATION OF STAR WHEELS & BALE RATE SENSOR	13
7. POWER CABLE AND MAIN WIRING HARNESS INSTALLATION	14
SYSTEM WIRING DIAGRAM	14
INSTALLATION OF CONTROLS	15
8. DESCRIPTION OF BUTTONS	16
9. FIRST TIME AND ANNUAL START UP INSTRUCTIONS	17
CHECKING AND PRIMING THE PUMPS	17
10. SETTING UP SYSTEM FOR INITIAL USE	18
APPLICATION RATE	18
BALING RATE	19
OPERATING INSTRUCTIONS	20-23
AUTOMATIC MODE	20
MANUAL MODE	21
JOB RECORDS	22
DIAGNOSTICS	23
COMMON QUESTIONS ABOUT THE 462	24
MAINTENANCE	25
WINTER STORAGE	25
TROUBLE SHOOTING CHECKS	26-27
BACKUP FUSE	27
WIRING DIAGRAMS	28-29
PARTS BREAKDOWN	30-36
MODEL 445 BASE KIT	30
PUMP PLATE	31
STAR WHEEL, BALE RATE SENSOR, AND HOSES	32
CONTROL BOX AND HARNESS	33
4409B CASE IH SBX 520, NEW HOLLAND 200 – 300 SERIES, 565 & OTHER	34
SQUARE BALERS	
4410B JOHN DEERE CONVENTIONAL SQUARE BALERS	35
4412B CLAAS, INTERNATIONAL, MASSEY FERGUSON, & WELGER	36
SQUARE BALERS	
4415B FOR CASE IH SBX 530 – 550 & NEW HOLLAND 570 –580	37
NOTES	38
TEMPLATE	39
4415 SPRAY SHIELD TEMPLATE	40
WARRANTY STATEMENT	BACK PAGE

INTRODUCTION

Congratulations on purchasing a Harvest Tec Model 445 applicator. This applicator is designed to apply Harvest Tec buffered propionic acid. The model 445 base kit includes the following parts: Tank, Frame, Pumps, Hose, Baler Mounted Processor, Touch screen display, Star wheels, and Miscellaneous Hardware. The applicator can be installed on most conventional balers with the proper installation kit. Before installing the unit on the baler, make sure you have the proper installation kit. (See the chart below.) If you are unsure about your installation kit contact your local dealership for specifications. For your convenience we have included a parts breakdown for the model 445 applicator. If something goes wrong, bring this manual into the dealership so they can order the correct parts for you. Ordering the correct part number is very important. It will save you time, money, and your crop.

INSTALLATION KIT REFERENCE CHART

<u>BALER MAKE</u>	<u>BALER MODEL</u>	<u>INSTALLATION KIT</u>
CASE IH	SBX530 – 550 SQUARE BALERS	4415B
CLAAS	MARKANT 55 / 65	4412B
INTERNATIONAL	ALL CONVENTIONAL SQUARE BALERS	4412B
JOHN DEERE	ALL CONVENTIONAL SQUARE BALERS	4410B
MASSEY FERGUSON	124 / 128	4412B
NEW HOLLAND	570 – 580 BALERS	4415B
WELGER	630 / 730 / 830	4412B
CASE & NEW HOLLAND & OTHER	SBX520 200 – 300 SERIES, 565 & ALL CONVENTIONAL SQUARE BALERS	4409B

TOOLS NEEDED

- Standard wrench set
- Standard socket set
- Standard screw driver or 5/16" nut driver
- Side cutter
- Hose cutter
- Crescent wrench
- Hammer
- Metal drilling and cutting tools
- Center Punch
- 1 1/2" (38 mm) hole saw 4415B install only

INSTALLATION OF APPLICATOR

1. INSTALLATION OF MOUNTING BRACKETS AND TANK

Install kit 4409B, 4410B, 4412B, and 4415B on all Case IH SBX, Claas, John Deere, International, New Holland, Massey Ferguson, and Welger small square balers

Mount the unit on the diagonal frame behind the twine box, as pictured using the base clamp and u-bolts.



JOHN DEERE



CASE & NEW HOLLAND

2. INSTALLATION OF TANK, REACH RODS, AND HOSE MANIFOLD

Install tank frame assembly to baler by sliding it over stub pipe of 001-4406 mounting bracket. After doing so, use ½" bolt to align and tighten down tank-frame assembly to mounting bracket. If your install kit includes reach rods, locate the top reach rod in a position opposing the overhanging tank. Bolt one end to the top stub pipe on the tank saddle and the other end to a secure location on the baler. **NOTE: REACH RODS MAY HAVE TO BE BENT ON THE TAB TO ALIGN PROPERLY.**

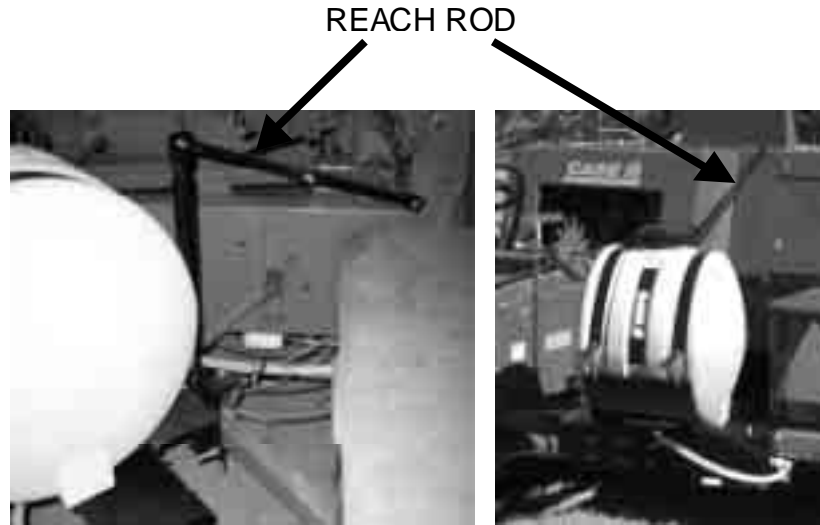

Mount the hose bracket on the front of the baler in the area of the spray shield. Make sure the bracket will not interfere with any baler operations.

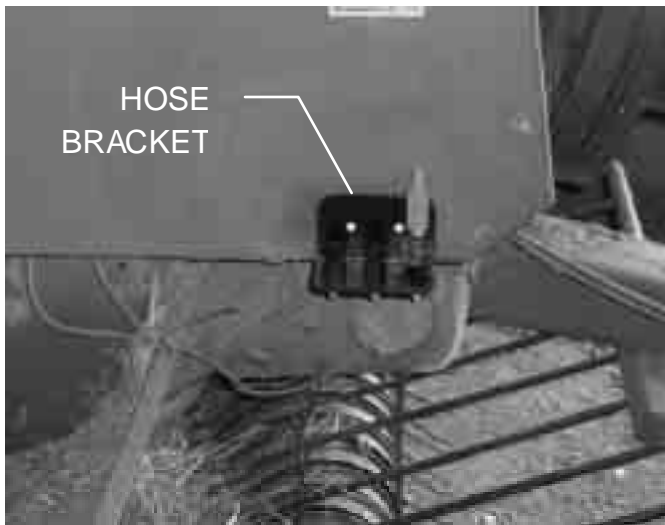

AGCO & CASE INLINE BALERS

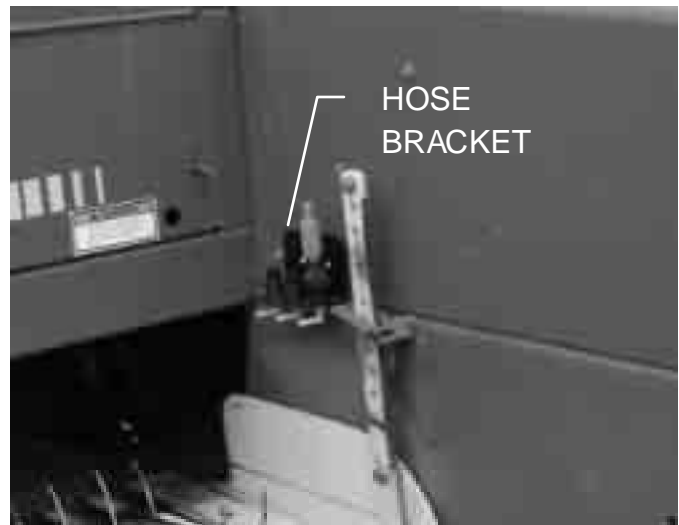

NEW HOLLAND & CASE SBX
WITH 4409B INSTALL KIT

3. INSTALLATION OF PUMP PLATE



Figure 1



Figure 2



Figure 3

A. ALL BALERS

The U shaped bracket (001-4647) will already be attached to the saddle and will need to be inverted to fit on the bottom of the saddle as shown in Figure 1. Reattach the bracket to the bottom of the saddle using the four 1/4 x 1 bolts, nuts, flats and lock washers. Connect the pump plate mounting bracket (001-4646C), shown in Figure 2, using two 3/8 x 1 1/4 bolts, nuts, locks, and flat washers to the U shaped bracket (001-4647). Install the rest of the pump plate as shown in Figure 3. Attach the pump plate holder (001-4646D) to pump plate mounting bracket (001-4646C) using four 3/8 x 3/4 flange head bolts. **The Baler Mounted Processor and pump heads must be pointing down. Failure to mount the pump plate assembly in this specified direction will void all warranty of the Baler Mounted Processor and pumps.**



Figure 4



Figure 5



Figure 6

B. ALTERNATE LOCATION FOR GROUND CLEARANCE

The U shaped bracket (001-4647) will already be attached to the saddle as shown in Figure 4. Connect the pump plate mounting bracket (001-4646C), shown in Figure 5, using two 3/8 x 1 1/4 bolts, nuts, locks, and flat washers to the U shaped bracket (001-4647). Install the rest of the pump plate as shown in Figure 6. Attach the pump plate holder (001-4646D) to pump plate mounting bracket (001-4646C) using four 3/8 x 3/4 flange head bolts. **The Baler Mounted Processor and pump heads must be pointing down. Failure to mount the pump plate assembly in this specified direction will void all warranty of the Baler Mounted Processor and pumps.**

4. PLACEMENT OF SPRAY NOZZLE ASSEMBLY

Install kit 4409B

Conventional baler with gathering forks.

1. Mount the left hand nozzle strap (it has an elbow fitting and a silver tip) so that it is approximately 80% across the width of the pick-up head. Example: if the head is 60" wide, locate the nozzle 48" from the right side of the head (60"x80".)
2. Mount the right hand nozzle strap (it has a tee fitting and a silver tip) so that it is approximately centered on the pickup head.
3. Place the two auxiliary nozzle straps in between the first two straps.
4. Bend the nozzle bar in so that the tip is pointed in toward the bottom of the gathering chamber and about 16" above the sheet metal base of the chamber. Twist the nozzle so the tip is tilted 45 degrees from horizontal
5. Three 1/4 inch lines will need to be run from the hose manifold to the nozzle straps. Use the color-coded stickers to attach the correct hose to the correct tips, and couplers. Secure the lines to the bracket and spray shield using the supplied hose clamps.

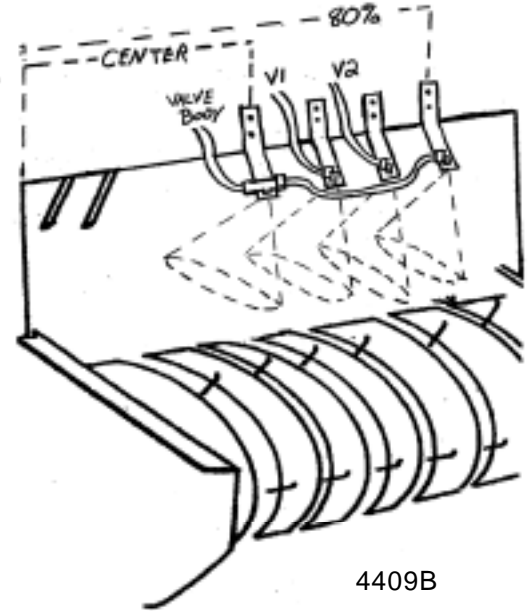

4410B

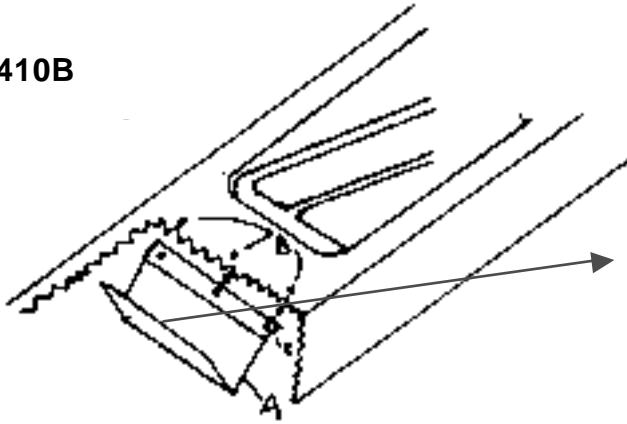

Install kit 4410B

Install hoses before installation of shield. Bolt the nozzle holder (A) up under the baler's hood. Remove 3 bolts (B) on the baler and replace with hardware in kit to fasten lip(C) securely in place. Three 1/4 inch lines will need to be run from the hose manifold to the spray shield. Use the color-coded stickers to attach the correct hose to the correct tips, and couplers. Secure the lines to the bracket and spray shield using the supplied hose clamps.

Install kit 4412B

Align the shield, with brackets attached, to the front sheet metal 10 – 14 inches (25 – 36 cm) from the edge of the knife in the baler chamber. The spray pattern should be aimed towards the middle of the baler chamber. Verify the mounting location will not interfere with any baler functions. Mark and drill 4 holes with a 10 mm drill bit. Install the shield using 3/8" x 1 1/4" bolts, flat and lock washers, and nuts.



Install kit 4515B

Locate the hay guard directly above the bale chamber. This install can be done with the hay guard in the baler, but it is recommended to remove. Consult your dealer for procedure.

Installation of spray shield

1. Mark a point 10" (25.40 cm) from the knife and centered on the hay guard. Next, mark a point 20" (50.80 cm) from the knife and centered on the hay guard. Using a straight edge draw a line between these two points.
2. Locate the template in the back on the manual. Align the template accordingly with the centerline and the correct side pointing towards the knife. The first point will align on the 10" (25.40 cm) mark from the knife. Tape the template to the hay guard following the centerline.
3. Center punch all five of the points on the hay guard. Verify measurements with template.
4. Remove the template and mark the center-punched points 1 through 5 starting at the point closest to the knife.
5. Drill all five holes with an 1/8" (3mm) drill bit **ONLY THROUGH THE TOP PIECE OF STEEL.**
6. At points 2, 3, and 5 drill only through the top of the hay guard with a 1 1/2" (38 mm) hole saw.
7. Drill points 1 and 4 through both the top and bottom steel using a 1/4" (6 mm) drill bit.
8. Insert two 1/4" x 2" button head cap screws through holes 1 and 4. The head of the screw will need to be down (in the chamber). Secure with nylon lock nut.
9. Place spray shield with plastic fittings down onto the hay guard. Secure with 1/4" flat washers and nut. Turn the white nylon fittings down until they touch the bottom of the hay guard. These fittings will be used as drill guides.
10. Drill through the bottom steel on holes 2, 3, and 5 with a 1/4" (6 mm) bit. Remove the shield and drill the holes with a 9/16" (14 mm) bit. Be careful to not oblong the holes. De-bur any metal filings left around the three holes on both sides of the hay guard.
11. Remove plastic drill guides from the shield and replace with the elbow fittings. Place the check valve, tip and cap onto the end of the elbow.
12. Thread the elbow with the blue tip into the low threaded hole on the shield. The medium will be the green tip, followed by brown at the high threaded hole. Do not thread all the way down, only start the elbows.
13. Place the shield on the hay guard and secure by pressing down. Thread all three elbows down until they touch the bottom metal.
14. Secure the spray shield with the knobs.

Installation of hose and support bracket

1. If the hay guard was removed for shield installation reinstall at this time.
2. Mark a point 6" from the first rotating tine on the center of the hay guard. Center punch this mark and drill a 1/4" (6 mm) hole through both top and bottom of the hay guard.
3. Bolt the bottom bracket (001-4425B) using 1/4" x 2" button head cap screw. Secure with a 1/4" flange nut. The head will need to be down (in the chamber).
4. Loosely install the remaining bracket (001-4425B) to the bottom bracket attaching in the middle. Level the two pieces and extend the top bracket until it reaches the top of the baler. Secure with a 1/4" flange bolt and nut.
5. Mark and drill the top hole with a 1/4" (6 mm) bit. Secure with a 1/4" flange bolt and nut.
6. Cut a 1 1/2" (38 mm) hole in the top of the baler for the hose to route through. Install the grommet once the hole is complete.
7. Attach the hose, to the elbows, securing with hose clamps. Clear hose to low, green to med., and blue to high.

8. Secure the low and medium hoses on the end of the spray shield with two jiffy clips (008-9014) and a 1/4" x 1/2" round head screw.
9. Install the hose from the shield under the hay tine, to the bracket, and out the top.
10. Secure the hose to the bracket with two jiffy clips (008-9009) and 1/4" flange bolts and nuts.
Keep the hose in the center of the bracket.
11. Run the hose through the top of the baler and down towards the tank. Use the supplied jiffy clips (008-9009) to secure in route to the tank.
12. Install the hoses on to the correct pumps. See plumbing section.

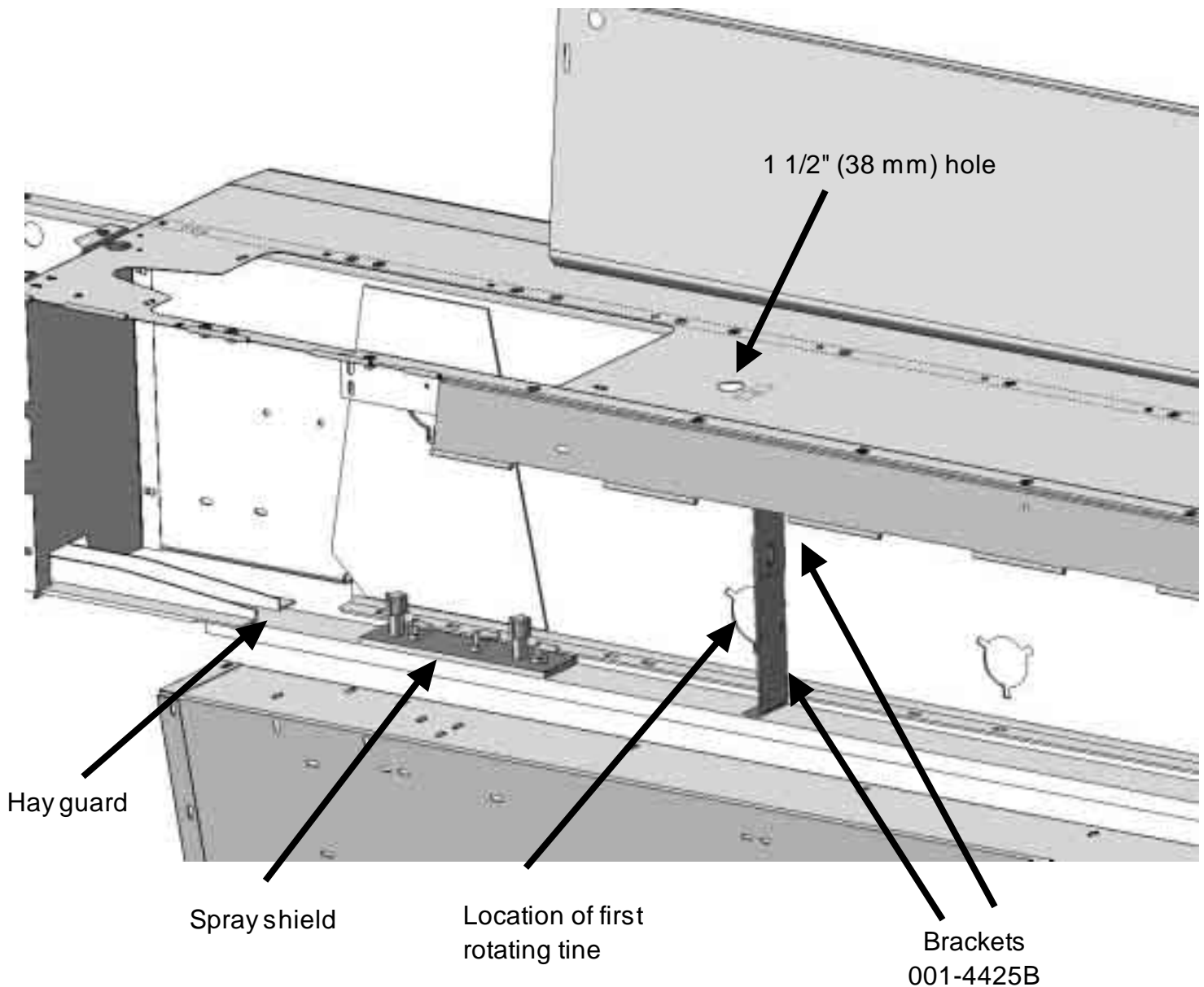

View from behind the twine box with the inspection door open.

5. INSTALLATION OF PLUMBING

For install kits 4409B, 4410B, 4412B

A. Intake

Use the 003-EL3412 on the bottom of the tank to route 1/2" line (002-9001) to the 003-A1212 fitting on the ball valve already attached to the pump plate. Attach hose clamps (003-9003) on both of the fittings.

B. Discharge

The three-1/4" hose assembly will be used to attach the pumps to the hose bracket. Use the color-coded stickers to attach the clear, green, and blue hoses to the proper pumps and couplers on the hose manifold. The same color-coded stickers will be used to attach the hoses from the hose bracket to the spray shield. (Pump 1 clear/white, Pump 2 green, Pump 3 blue.)

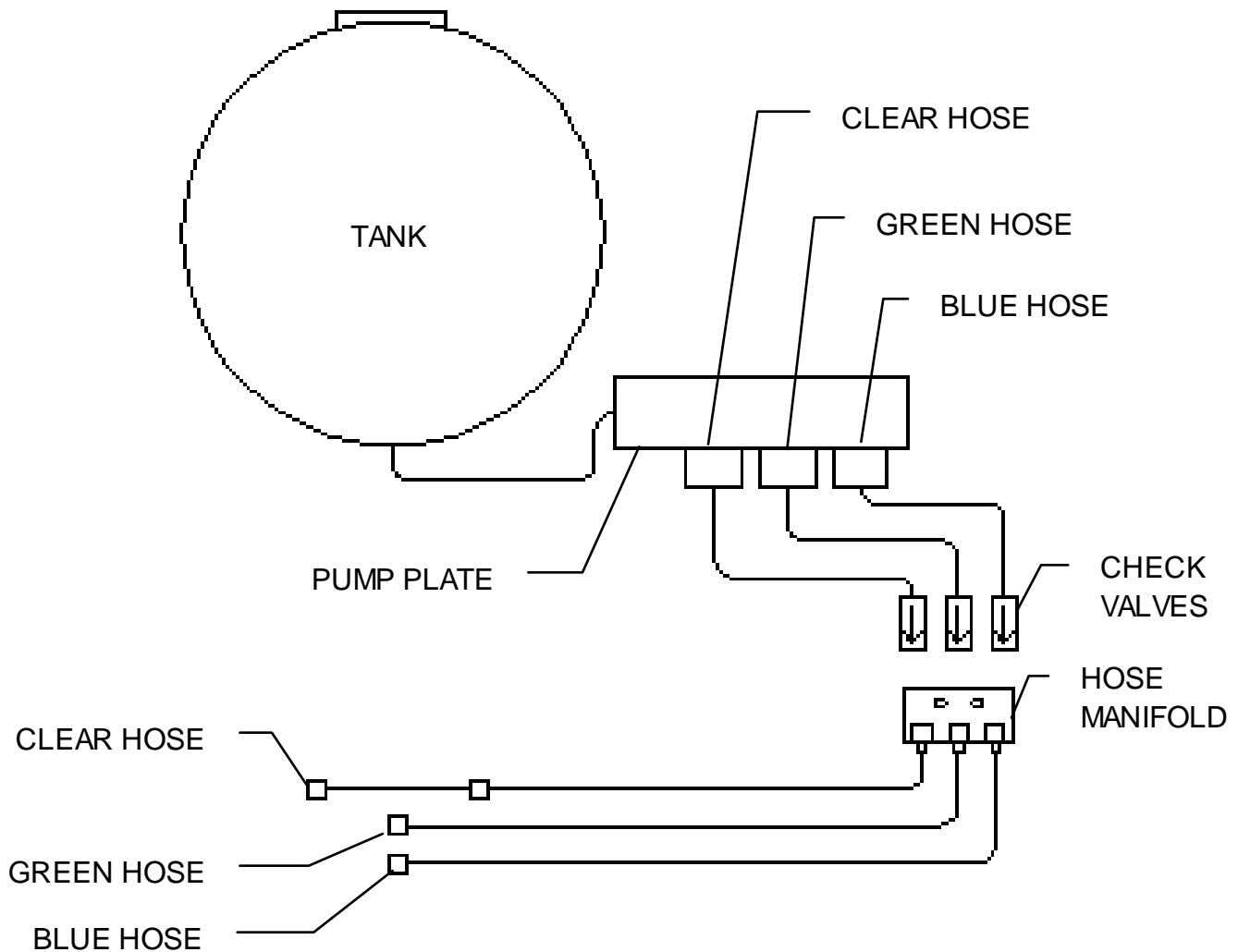

For install kit 4415B

A. Intake

Use the 003-EL3412 on the bottom of the tank to route 1/2" line (002-9001) to the 003-A1212 fitting on the ball valve already attached to the pump plate. Attach hose clamps (003-9003) on both of the fittings.

B. Discharge

The three-1/4" hose assembly will be used to attach the pumps to spray shield. Use the color-coded stickers to attach the clear, green, and blue hoses to the proper pumps and elbows on the spray shield. (Pump 1 clear/white, Pump 2 green, Pump 3 blue.)

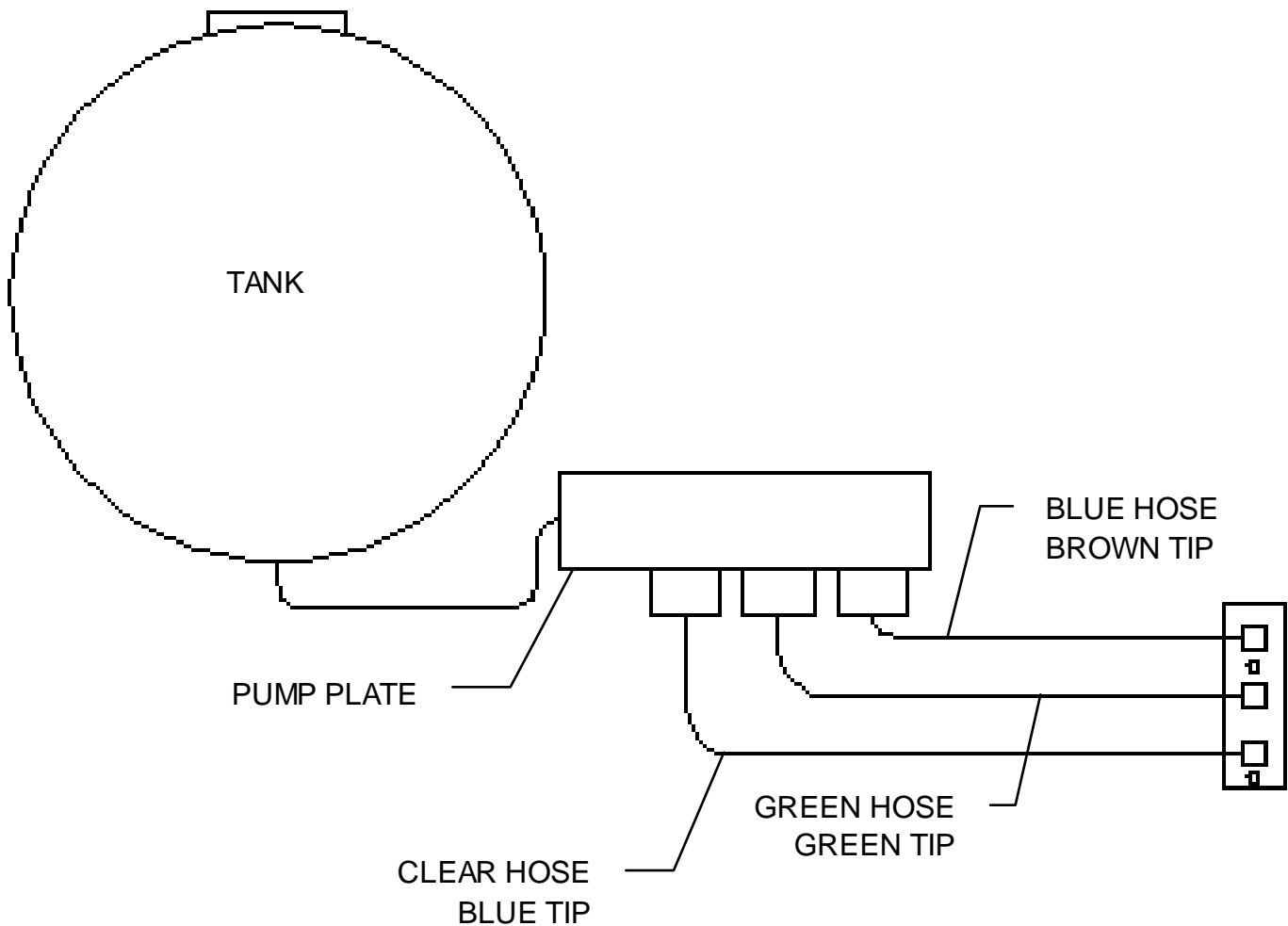

6. INSTALLATION OF STARWHEELS & BALE RATE SENSOR

The pair of star wheels will need to mount on the bottom side as close to the front of the bale chute as possible and at least 3/8" away from any metal. They will need to maintain a safe distance away from the twine.

The star wheels will require two holes to be drilled per block, when drilling make sure to keep the wheel square to the bale chamber. Any angle will cause stress on the wheel and will eventually cause the wheel to work itself out of the block. Some balers may require a notch cut on the bottom of the bale chamber to mount the star wheels as close to the front of the chamber as possible. Use the template in back of manual to aid in installation.

Use the supplied bolts and place the carriage head inside of the bale chamber followed by lock and nut. Next attach the star wheels to the bolts followed by flat washer, lock washer and nut. The driver side star wheel will have the bale rate sensor bolted to the bottom of the block. The sensors need to be no more than 1/4 inch away from the star wheel itself. The cable will attach to the BMP at the bale rate sensor port.

Remove the four screws holding the plastic cover and attach one wire eye loop per star wheel through the grommet and tighten down with the nut attached to the swivel. Reinstall the cover and run the wires up to the pump plate. You will need to use zip ties to attach the wires so as to not interfere with normal baler use.

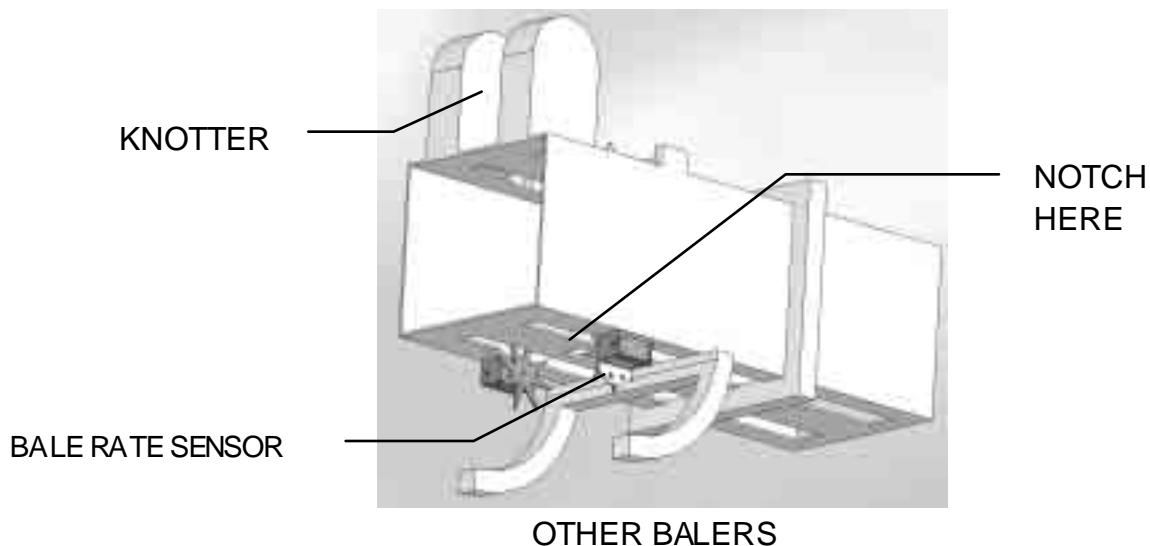
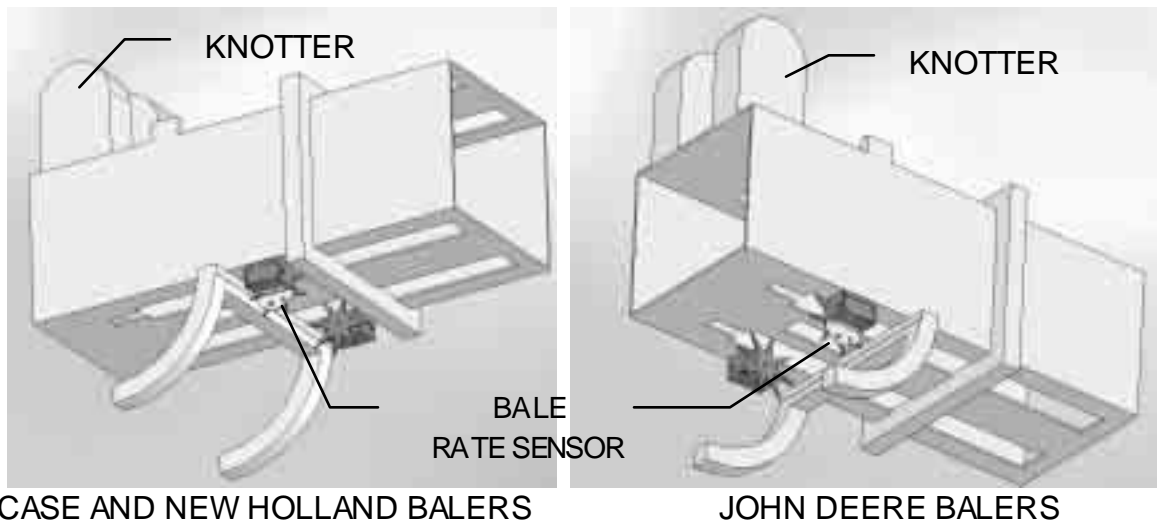

7. POWER CABLE AND MAIN WIRING HARNESS INSTALLATION

1. Locate the power harness.
2. Connect the power harness (006-4640A) to the battery (12 volt) using the red wire with fuse to the positive side and the black wire to the negative.



A) The power harness must be connected to the battery! The unit will draw more amps than convenience outlets can handle. Any modifications of the power harness will void systems warranty. **CONTACT HARVEST TEC IF MODIFICATION IS REQUIRED!**

B) This unit will not function on positive ground tractors.

C) If the unit loses power while operating it will not keep track of accumulated pounds of product used.

3. The power harness (006-4640A) will run from the tractor battery to the hitch. The power harness (006-4660K) will connect to the tractor power harness (006-4640A) at the hitch. Run the Communication harness (006-4660N) from the cab to the hitch. This wire will connect to the Communication harness (006-4660L). These wires will run together to the Baler Mounted Processor (006-4671SS).
4. Connect Flow Meter (006-4725A) to the Baler Mounted Processor.
5. Connect Pump Harness (006-4660Z) the Baler Mounted Processor.
6. If you have the optional Hay Indicator connect it to the Baler Mounted Processor.
7. Attach moisture cable (006-4640D) to Baler Mounted Processor.
8. Connect bale rate sensors cable (006-7202) to the Baler Mounted Processor.
9. Install Baler Mounted Processor in pump plate using 5/16" lock, nut and flat washers.

NOTE: The plugs on the Baler Mounted Processor must face down. Failure to mount correctly will void systems warranty.

SYSTEM WIRING DIAGRAM

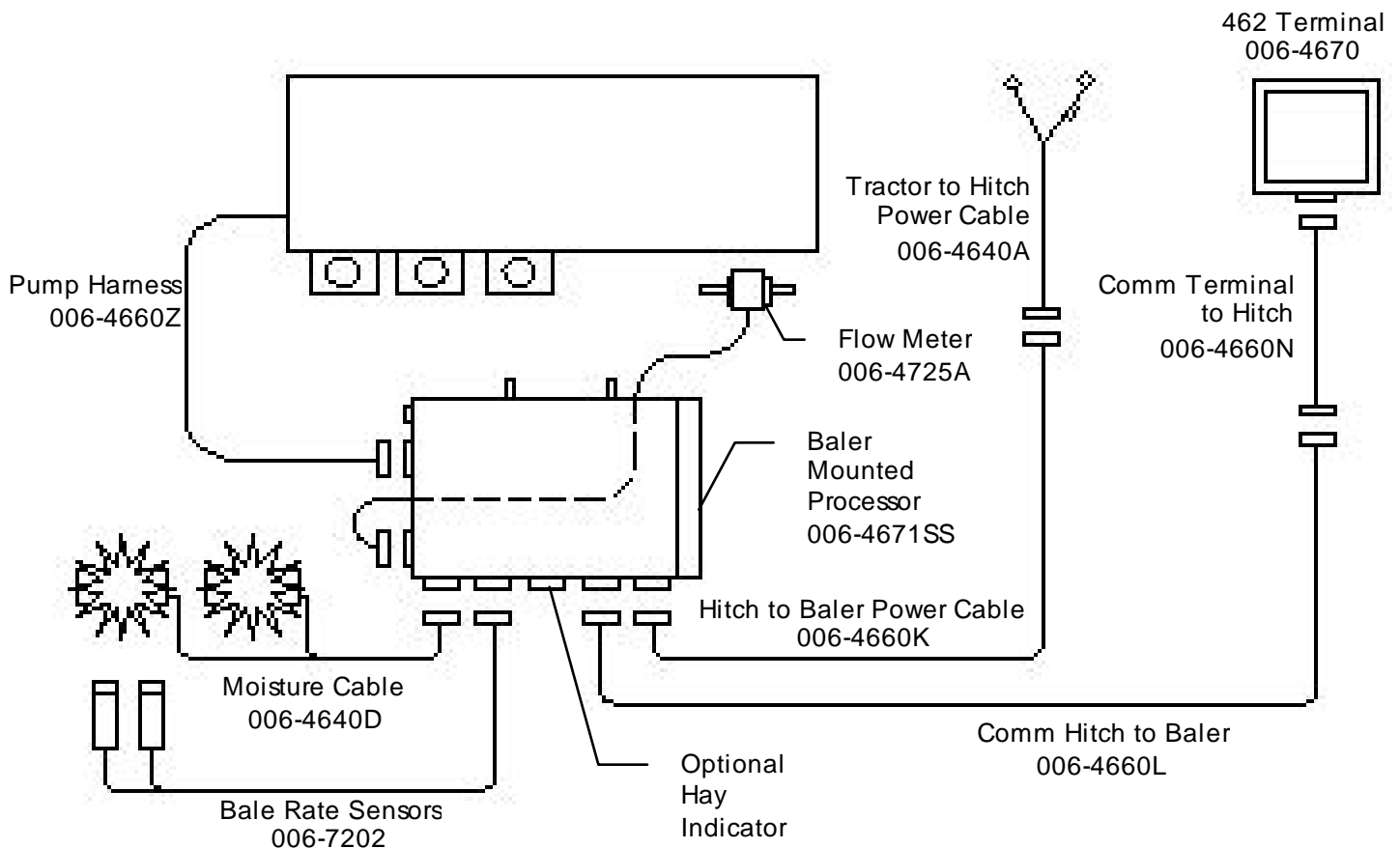

INSTALLATION OF CONTROL

INSTALL THE MOUNTING BRACKET FOR THE CONTROL IN THE CAB.

Use the four mounting screws to mount the round base in a convenient area in your cab or on your fender. If unit is mounted on fender it will need to be removed at night and stored in a clean and dry area.

Use the ram mount swivel-positioning nut to tighten the entire assembly. Adjust it so that you can view the entire screen and be able to use the touch screen without interfering with other tractor functions.

Connect communication wire (006-4660N) to the bottom of the terminal.

8. DESCRIPTION OF BUTTONS

This system is calibrated for use with Harvest Tec buffered propionic acid. It is designed to apply rates of 16 to 300 pounds (8 to 252 litres) of acid per hour and read moisture levels of 10 to 32 percent. The 462 monitor will allow you to set your bale weight, single bale formation time, moisture levels and application rates. The Automatic Mode option will automatically adjust the application rates as the moisture level changes. Manual Mode will allow you to control the application rates on the go. To turn the display on, press anywhere on the right side of the screen followed by pushing the “Press to Start” key.

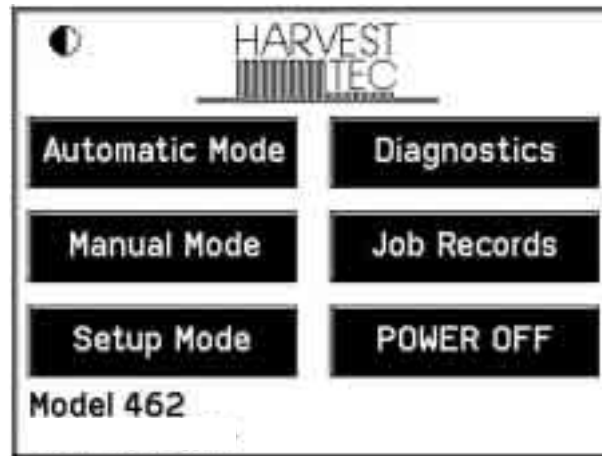

AUTOMATIC MODE This mode allows you to use all of the applicator's features such as adjusting preservative application on the go and counting total pounds (litres) of product used.

MANUAL MODE Allows operator to manually turn pumps on and off. This mode also has moisture content displayed. Use this mode to prime pumps.

SETUP MODE This mode allows the operator to adjust bale rate, application rate settings, and switch between metric and standard units.

DIAGNOSTICS Allows operator to automatically check performance and output of pumps as well as set the date and time.

JOB RECORDS Keeps track of up to 63 jobs with total product used, average moisture content, total tons (tonnes) baled, and date of baling.

POWER OFF This key turns the unit off. To turn the unit on, simply press anywhere on the right side of the screen.

 **CONTRAST** This button is your contrast control. Press this button to lighten the screen. When the screen reaches its lightest point, pressing again will return to the darkest setting. Fine tuning the contrast can be accomplished by turning the knob on the bottom right side of the enclosure.

9. FIRST TIME AND ANNUAL START UP INSTRUCTIONS

AFTER INSTALLATION THE UNIT MUST BE CHECKED OUT BEFORE FIELD OPERATION!!

CHECKING AND PRIMING THE PUMPS

1. Put 10 gal of water in tank and turn main ball valve on.
2. Inspect for any leaks or drips at this time. If any are found tighten or replace area or fitting.
3. **Turn controller on** (push anywhere on the screen) followed by pushing the "Press to Start" key.
4. Press the SETUP MODE key. (**See page 19**) **Select Sensors are: OFF** to disable bale rate sensors. Make sure the AVG Bale Weight is 100 lbs (45kg) and the AVG Baler Length is 36 in (91 cm) and EST Baling Time is 10 sec. Press the MAIN MENU key to return to the opening screen.
5. Press the MANUAL MODE key.
6. The screen shown below should appear.

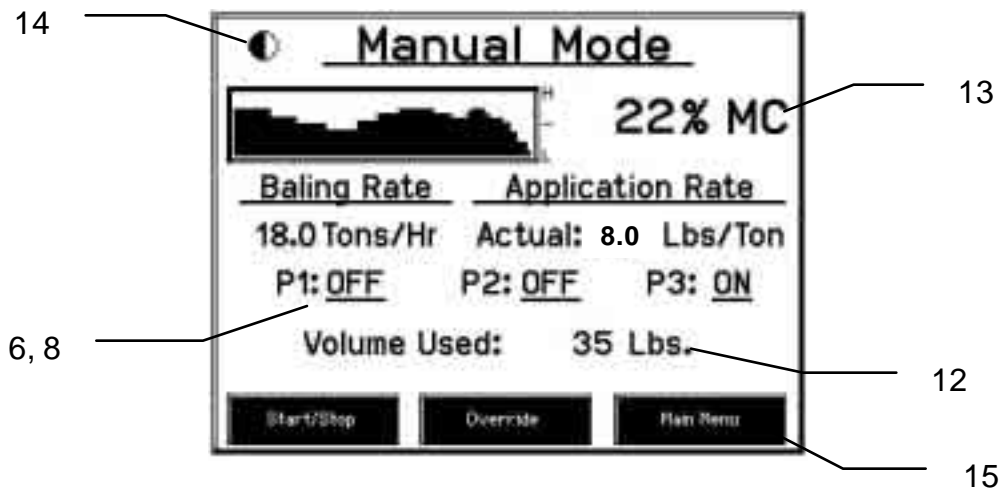

7. **For Conventional Square balers:** Turn pump 1 on (P1). To do this press the underlined area on the screen which says OFF. The application rate should then read between 1.2 – 1.6 Lbs/Ton (0.5 – 0.7 L/MT). Ideally, at 13.5 volts, the rate would read 1.4 Lbs/Ton (0.6 L/MT).
8. Repeat the process for pumps 2 and 3 (P2 and P3). The application rate should read between 3.6 – 5.0 Lbs/Ton (1.5 – 2.1 L/MT) and 6.7 – 9.3 Lbs/Ton (2.8 – 3.9 L/MT) respectively. Ideally, at 13.5 volts, the rate for pump 2 would be 4.3 Lbs/Ton (1.8 L/MT); pump 3 would be 8.0 Lbs/Ton (3.4 L/MT).
9. **For Three Tie:** Turn pump 1 on (P1). To do this press the underlined area on the screen which says OFF. The application rate should then read between 1.8 – 2.6 Lbs/Ton (0.8 – 1.1 L/MT). Ideally, at 13.5 volts, the rate would read 2.2 Lbs/Ton (0.9 L/MT).
10. Repeat the process for pumps 2 and 3 (P2 and P3). The application rate should read between 3.6 – 5.0 Lbs/Ton (1.5 – 2.1 L/MT) and 9.7 – 13.4 Lbs/Ton (4.1 – 5.6 L/MT) respectively. Ideally, at 13.5 volts, the rate for pump 2 would be 4.3 Lbs/Ton (1.8 L/MT); pump 3 would be 11.4 Lbs/Ton (4.8 L/MT).
11. **This process will also be used to prime the pumps whenever needed.**
12. While running pumps check for a good spray pattern out of the respective tips and verify that no parts of the system are leaking.
13. While doing these tests the Volume Used on the bottom of the screen should be counting up, this verifies that the flow meter is functioning.
14. In order to check moisture reading, have an assistant grab the star wheels. The moisture should read between 17-25 percent depending on how moist their hands are.
15. This button is your contrast control. Press this button to lighten the screen. When the screen reaches its lightest point, pressing again will return to the darkest setting.
16. Press the MAIN MENU key to return to the initial start up screen.

10. SETTING UP SYSTEM FOR INITIAL USE

IN THIS MODE YOU WILL SETUP YOUR INITIAL APPLICATION RATE AND BALING RATE

APPLICATION RATE

After pushing the SETUP MODE key in the Main Menu screen, the top screen should appear:

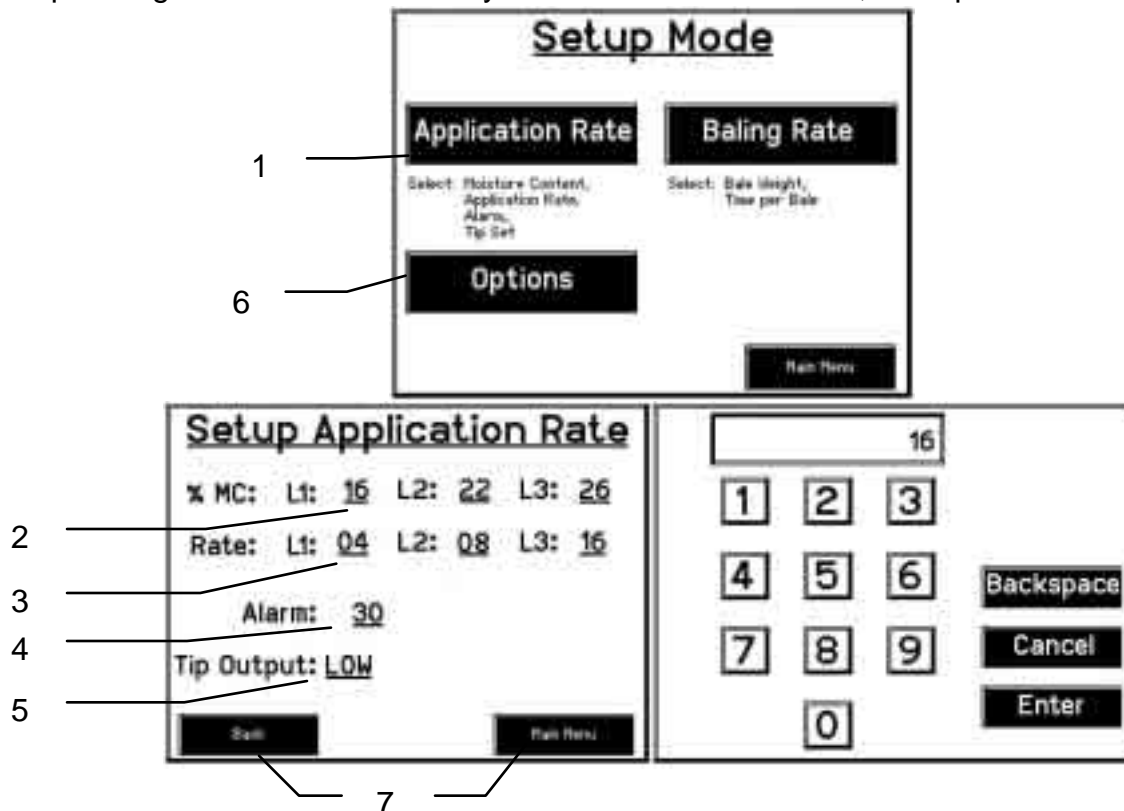

1. On this screen the operator will press the APPLICATION RATE key. Once pressed the SETUP APPLICATION RATE screen will be shown. (bottom left picture)
2. Press any of the underlined numbers to the right of %MC to adjust their figures. The key pad shown on the bottom right will display. Remember level 1 must be lower than level 2 and level 2 must be lower than level 3. Harvest Tec products recommend set points of 16, 22, and 26% MC levels. These are preset from the factory. Press ENTER to return to previous screen.
3. To change rate of chemical application press any of the underlined numbers to the right of the RATE:. The key pad shown on the bottom right will display. Remember level 1 must be lower than level 2 and level 2 must be lower than level 3. Harvest Tec products recommend rates of 4,8, and 16 lbs/ton (2, 4, and 8 litres/tonne). These rates are preset from the factory. Press ENTER to return to previous screen. **IT IS THE OPERATORS RESPONSIBILITY TO FOLLOW THE RECOMMENDATIONS OF THE PRESERVATIVE. ONLY THE OPERATOR CAN APPLY THE PROPER RATE.**
4. To set the alarm press on the underlined area. Set the level at which you want the alarm to activate. To turn the alarm off, set level above 35.
5. The TIP OUTPUT should always read LOW for small square balers; only use HIGH for three tie balers. The TIP OUTPUT key allows the operator to select between high and low outputs.
6. Press the OPTION key to adjust the touchscreen between metric and standard units.
7. Next press the BACK key found on the bottom left hand of the screen to return to the previous screen or press MAIN MENU key on the bottom right hand of the screen to return to the opening screen.

BALING RATE

After pushing the SETUP MODE key in the Main Menu screen, the top screen should appear:

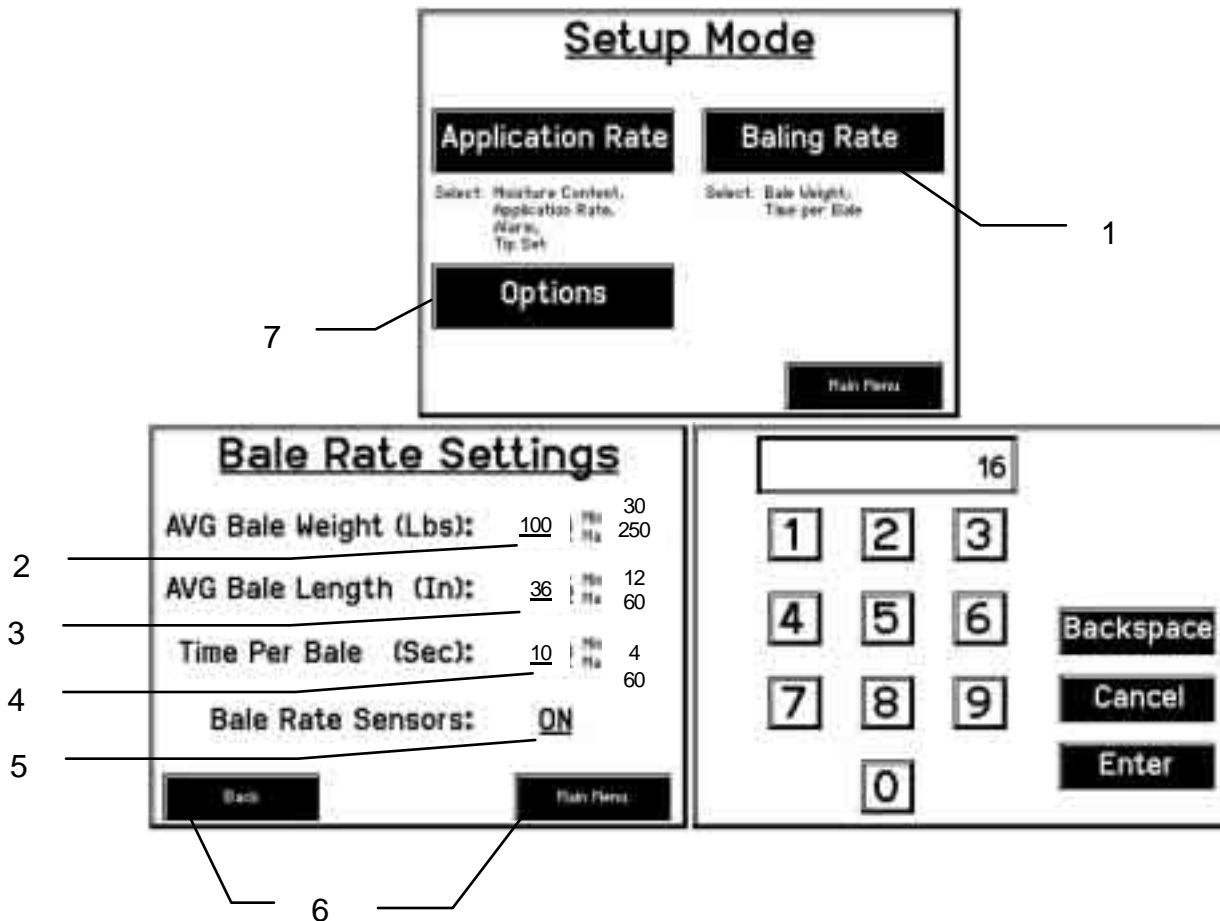

1. On this screen the operator will press the BALING RATE key. This screen is shown on the bottom left picture shown above.
2. Press the underlined number to the right of AVG Bale Weight (Lbs or Kg): to adjust the weight of your bales. The keypad shown on the right side will display. Press any number combination in this screen within the min/max limits. Press the ENTER key to save this information. The information will remain until it is changed again.
3. Press the underlined number to the right of AVG Bale Length (In or cm): to adjust the length of your bales. The keypad shown on the right side will display. Press any number combination in this screen within the min/max limits. Press the ENTER key to save this information. The information will remain until it is changed again.
4. Press the underlined number to the right of EST Baling Time (Sec): to adjust the time it takes to make a bale. The keypad shown on the right side will display. Press any number combination in this screen within the min/max limits. Press the ENTER key to save this information. The information will remain until it is changed again.
5. If the unit will be run with the bale **sensors on**, then the bale weight and length will need to be inputted. When the **sensors are:** on, the applicator will calculate your tons per hour. When the **Sensors are:off** (as shown above), a constant tons per hour (your inputted bale weight and time) will be used. Press the underlined word to toggle between on or off.
6. Next press the BACK key found on the bottom left hand of the screen to return to the Setup Mode screen, or press the MAIN MENU key on the bottom right hand of the screen to return to the opening screen.
7. Press the OPTION key to adjust the touchscreen between metric and standard units and languages.

OPERATING INSTRUCTIONS

Auto mode will automatically apply product based on both hay moisture content sensed by the star wheels and the operator's presets. (See SETTING UP SYSTEM FOR INITIAL USE to change any of these settings). **Manual mode will apply preservative to the hay at a fixed rate regardless of the moisture content.**

AUTOMATIC MODE

After pushing the AUTOMATIC MODE key in the Main Menu screen, the following screen should appear:

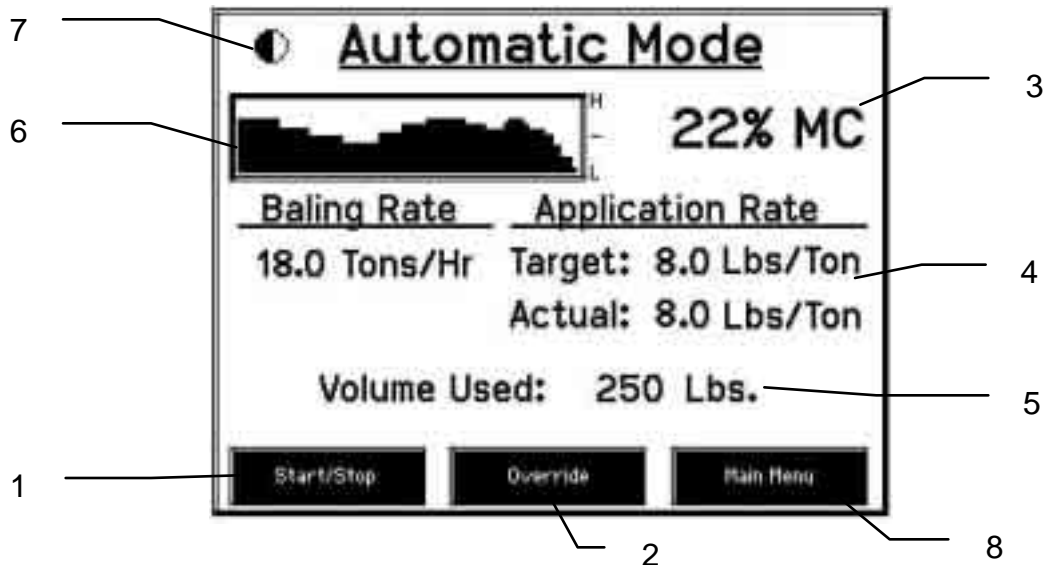

1. Push the START/STOP key to pause the unit while in operation.
2. Push the OVERRIDE key to turn on all three pumps at the same time for full output of the system. Use this mode when going through a short area of wet crop.
3. The moisture content is shown in the upper right hand corner.
4. Baling Rate and Application Rate are shown in the middle. The operator sets the target application rate in the setup mode; the actual rate should be within +/- one pound (litre) when running. The baling rate is also set in Setup Mode.
5. Volume used shown at the bottom of the screen will show accumulated pounds (litres) of preservative used on the go. This number will reset at power down, but remains in the job record screen. **NOTE: Initial start-up requires pressing the New Job key in the Job Records screen in order for Volume Used accumulation to be recorded. This only needs to be done once on initial start-up of system and not every time the system is started for operation.** (See JOB RECORDS screen)
6. The graph shows the moisture trend from the past 90 seconds in 3 second intervals.
7. This button is your contrast control. Press this button to lighten the screen. When the screen reaches its lightest point, pressing again will return to the darkest setting.
8. Press the MAIN MENU key to return to the opening screen.

MANUAL MODE

After pushing the MANUAL MODE key in the Main Menu screen, the following screen should appear:

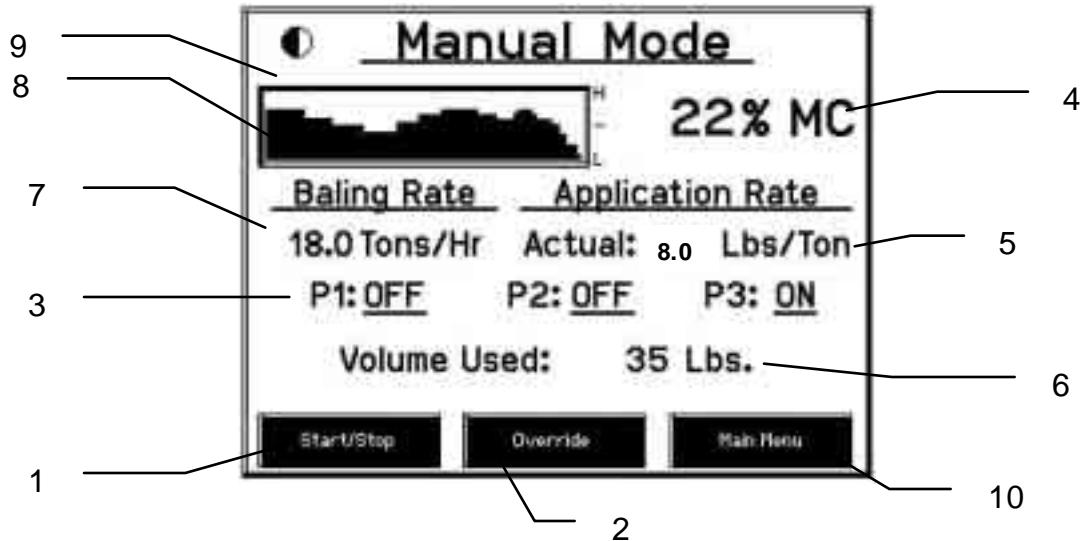

1. Push the START/STOP key to pause the system while in operation.
2. Push the OVERRIDE key to turn on all three pumps at the same time for full output of the system. Use this mode when going through a short area of wet crop.
3. In Manual Mode you can turn the pumps on or off by pressing the underlined area next to the pump numbers. In Manual Mode (regardless of baling rate, moisture, or bale weight) the outputs of the pumps are fixed rates as follows:

Pump outputs for Three Tie (High):

Pump 1 = 40 LBS/HR (17 L/HR)
 Pump 2 = 75 LBS/HR (32 L/HR)
 Pump 3 = 205 LBS/HR (86 L/HR)

Conventional Square (Low):

Pump 1 = 25 LBS/HR (11 L/HR)
 Pump 2 = 75 LBS/HR (32 L/HR)
 Pump 3 = 145 LBS/HR (61 L/HR)

4. The moisture content is shown in the upper right hand corner.
5. Baling rate and Application rate are shown in the middle. The output of a pump can be checked by dividing the preset output (shown in step 3, above) by the displayed baling rate. For example, if you are running pump three, by itself for conventional square, your output is 145 lbs/hr (65 L/HR). Given the baling rate shown on the above screen of 18 tons/hr (16.3 MT/hr), the application rate should be about 8.0 lbs/ton (3.6 L/MT) (145 lbs/hr divided by 18 tons/hr).
6. Volume used shown at the bottom of the screen will show accumulated pounds (litres) of preservative used on the go. This number will reset at power down, but remains in the job record screen. **NOTE: Initial start-up requires pressing the New Job key in the Job Records screen in order for Volume Used accumulation to be recorded. This only needs to be done once on initial start-up of system and not every time the system is started for operation.** (See JOB RECORDS on the following page)
7. The baling rate is set in the Setup Mode menu.
8. The graph shows the moisture trend from the past 90 seconds of baling time (one reading every three seconds).
9. This button is your contrast control. Press this button to lighten the screen. When the screen reaches its lightest point, pressing again will return to the darkest setting.
10. Press the Main Menu key to return to the opening screen.

JOB RECORDS

After pushing the JOB RECORDS key in the Main Menu screen, the following screen should appear:



1. The job number will be displayed in the top left corner and will move to the next job when the NEW JOB key is pressed. The current job being viewed will always read "Job #: 0". Product used and average moisture content will be reset when the NEW JOB key is pressed. The job records screen will store up to 63 jobs and will allow you to access previous jobs by using the up and down arrows found on the right side of the screen.
2. Scrolling through previous jobs is done by pressing the UP or Down keys.
3. **Every time the NEW JOB key is pressed the accumulated pounds on auto and manual modes will be reset to zero.** After 63 jobs have been stored, the next time the NEW JOB key is pressed the system will start over with job one and the old job will be replaced.
4. Highest moisture content will display moistures up to 33%. Any moisture recorded higher than 33 % will register only as 99%.
5. To return the opening screen, press the MAIN MENU key.

NOTE: Initial start-up requires pressing the New Job key in the Job Records screen in order for Volume Used accumulation to be recorded. This only needs to be done once on initial start-up of system and not every time the system is started for operation.

DIAGNOSTICS

After pushing the DIAGNOSTICS key in the Main Menu screen, the following screen should appear:

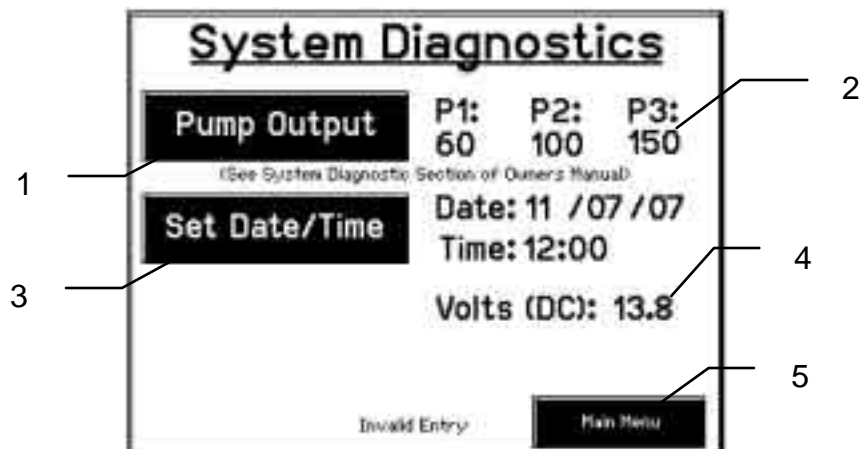

The diagnostic mode will automatically check the pump output and performance of the three pumps. It is recommended to use this mode daily to ensure proper system performance.

Acceptable ranges for output:

Low output tips:

Pump 1 = 21 - 30 LBS/HR (9 - 13 L/HR)
Pump 2 = 64 - 88 LBS/HR (27 - 37 L/HR)
Pump 3 = 123 - 170 LBS/HR (52 - 72 L/HR)

High output tips:

Pump 1 = 34 - 47 LBS/HR (14 - 20 L/HR)
Pump 2 = 64 - 88 LBS/HR (27 - 37 L/HR)
Pump 3 = 175 - 240 LBS/HR (73 - 101 L/HR)

- Once the screen is displayed, press the PUMP OUTPUTS key.
The machine will cycle all three of the pumps for 15 seconds. After the cycles are complete, the system will display a number next to each pump number.
- If the system displays within the listed range.**
 - The system is operating correctly.**If the system displays higher than the listed range, some common problems could be:**
 - Leak in line. Inspect lines thoroughly.
 - Tip missing. Check for lost or broken tip on spray shield.
 - Tip worn. Replace tip.
 - High tractor voltage.**If the system displays lower than the listed range, some common problems could be:**
 - Make sure there is preservative in the tank and ball valve is in the open position.
 - Air in lines. Pump will not prime. Check for leak in lines, or defective check valve.
 - Pump is working, but not producing desired output. Pump needs to be rebuilt.
 - Main filter plugged. Check filter by tank and clean if necessary.
 - Tip or tip screen plugged. Check both tip and tip screen and clean if necessary.
 - Kink in hose. Straighten or replace hose.
 - Voltage from tractor is low. Check power cord with multimeter for 12 volts at baler mounted processor. Clean connections on battery. Dielectric grease connections at baler mounted processor and at hitch connection.
 - Pump is defective. Rebuild pump if motor runs smoothly. Replace pump if motor is bad.
 - Defective flow meter. Only if all pumps run, product is applied, and all numbers read 0.
- To set date and time, press the SET DATE/TIME key. In the next screen enter the date (month, day, year format) followed by the time. When done press the ENTER key. NOTE: The clock uses military (or 24 hour) time.
- The voltage should be between 12.0 to 14.5 volts for the system to work properly. If voltage is not in this range check all power cord connections and the tractors charging system.
- When done in this mode, press the MAIN MENU key.

COMMON QUESTIONS ABOUT THE 462

1. How do I turn the system on/off?

To turn the system ON simply press anywhere on the right side of the screen followed by pushing the press to start key. To turn the system OFF, return to the Main Menu screen and press the POWER OFF key.

2. How to get in the LBS/TON (L/MT), MC%, and TONS/HR (MT/HR) menus?

In the Main Menu press the SETUP MODE key. From this screen you can change your application rates and how much product is applied. See SETTING UP FOR INITIAL USE for a detailed explanation of this process.

3. The unit is stuck in the MC% screen.

In the MC% screen, level 1 must be less than level 2, and level 2 must be less than level 3. For example, if level 1 is set at 16, level 2 must be set at 17 or higher, and level 3 must be set higher than level 2.

4. How does OVERRIDE work?

Override turns on all three pumps at full output. The pumps will remain at full output until the operator turns these pumps off by pressing the OVERRIDE key again.

5. The flow meter reading is more or less than the programmed level set in the box.

Some variation in flow meter readings compared to the programmed set point is normal due to factory tolerances on the pump motors as well as varying tractor voltages inputted to the control box. The flow meter reading is an accurate measure of how much product is actually being applied. The set points then will need to be adjusted if you want to attain a different flow meter reading.

6. Why don't all the pumps turn on even at higher application rates?

The selections of what pumps turn on when are automatically controlled by the control box's flow rate look up chart. Thus, not all the pumps turn on at once and the combination of what pumps turn on when is automatically controlled by the software. If you want to make sure all three pumps are working, go to the Diagnostics screen and run pump outputs.

7. The moisture content displays "LO" or "HI" all the time.

When the moisture content display does not change frequently while baling, there is likely a faulty star wheel connection. One of the first places to check is inside the white star wheel block. Check to see if the electronic swivel is in the star wheel shaft and check to see that the star wheel shaft is not working out of the block. Also, check all star wheel wires and connectors to see if there is a continuity or grounding problem.

8. Should the battery connections be removed before jump starting or charging a battery?

Yes. Anytime the tractor will have voltage going up rapidly the connections should be removed.

MAINTENANCE

1. Clean the tip strainers and main strainer every 10 hours of operation or more frequently if required.
2. Depending on the product being used, the system may need to be flushed with water at a regular interval (consult with manufacturer of the chemical.) If Harvest Tec product is being used, flushing is not necessary.
3. Although the pump can run dry, extended operation of a dry pump will increase wear. Watch the preservative level in the tank.
4. Cover the automatic cab terminal on open station tractors if left outside.
5. Pump performance may start to decline after 400 hours (1500 acres on conventional balers) of use. Rebuilding pumps is a simple procedure if the motor is not damaged. Order pump rebuilding kit #007-4581 for the automatic unit.
6. If you are using bacterial inoculants, flush your system daily after every use.
7. Clean tank cap every 10 hours of operation.

Maintenance Schedule

	Daily	10 hrs	400 hrs	Weekly	Monthly	Season
Diagnostics	X					X
Filter bowl cleaning		X				X
Tip screen cleaning		X				X
Tank cap cleaning		X				X
Dielectric grease connections					X	X
Rebuild pump			X			
Battery connections				X		X
Check valves			X			
Visually inspect hoses				X		X

WINTER STORAGE

1. Thoroughly flush the system with water.
2. Remove the filter bowl and run dry until the water has cleared out of the intake side.
3. Remove the red plug from the bottom of the pump, drain, and run the pump for 30 seconds or until it is dry.
4. Drain all lines on the outlet side.
5. Never use oils or alcohol based anti-freeze in the system.
6. During spring start-up, if the pump is frozen turn off the power immediately to avoid burning the motor out. The pump head can be disassembled and freed or rebuilt in most cases.
7. Disconnect power from system.
8. Remove display from tractor and store in a warm dry place.

TROUBLE SHOOTING CHECKS:

PROBLEM	POSSIBLE CAUSE	SOLUTION
Pump will not run.	1. No voltage to Baler Mounted Processor.	1. Check for short, low voltage, and replace fuse if necessary.
	2. Pump locked up.	2. Clean or rebuild pump if motor is OK.
	3. Damaged wire.	3. Repair damaged wire.
Pump runs but will not prime.	1. Air leak in intake.	1. Tighten fittings on intake side.
	2. Clogged intake.	2. Clean.
	3. Restricted outlet.	3. Check and clean tips.
	4. Check valve on outlet stuck closed.	4. Clean or repair check valve.
	5. Dirt inside pump.	5. Replace pump check valve.
Pump does not develop enough output.	1. Air leaks or clogs on inlet side.	1. Tighten or clean filter bowl assembly.
	2. Pump worn or dirty.	2. Rebuild pump.
Moisture reading errors (high or low)	1. Wire disconnected or bad connection between star wheels and baler mounted processor.	1. Reconnect wire.
	2. Low power supply to baler mounted processor.	2. Check voltage at box. (Min of 12 volts required.) See Diagnostics section of manual.
	3. Wet hay over 32% moisture	
	4. Ground contact with one or both star wheels and baler mounted processor.	4. Reconnect.
	5. Short in wire between star wheels and baler mounted processor.	5. Replace wire.
	6. Check hay with hand tester to verify.	6. Contact Harvest Tec if conditions persist.
Moisture readings erratic.	1. Test bales with hand tester to verify that cab monitor has more variation than hand tester.	
	2. Check all wiring connections for corrosion or poor contact.	2. Apply dielectric grease to all connections.
	3. Check power supply at tractor. Voltage should be constant between 12 and 14 volts.	3. Install voltage surge protection on tractors alternator.
Flow meter readings do not match up with product usage.		
Product is less than actual product used.	1. Voltage supplied to meter is less than 6 volts.	1. Check for a min of 6 volts supplied at baler mounted processor.
	2. Wiring short in signal to baler mounted processor.	2. Inspect wire and replace if necessary.
	3. Clog in meter.	3. Back flush with water. DO NOT USE AIR.

	4. Using product other than Harvest Tec.	4. Catch and weigh product to check outputs.
Product shown is more than actual product used.	1. High voltage supplied to the meter.	1. Check voltage at baler mounted processor. Max of 18 volts.
	2. Light interference with meter.	2. Reflection into meter can cause a high reading. Move meter or protect from sunlight.
	3. Air leak in intake.	3. Look for air bubbles in line. Replace line or other defective area that is allowing air into the system.
	4. Using product other than Harvest Tec.	4. Catch and weigh product to check outputs.
System leaks product out of tips after shutdown.	1. Dirty or defective check valves.	1. Clean or Replace.
Terminal reads under or over power.	1. Verify with mult-meter actual voltage. Voltage range should be between 12-14 volts.	1. Clean connections and make sure applicator is hooked to battery. See Diagnostics section of manual.
System always displays "End of Row Pause".	1. Flow meter connector plug is plugged into Hay Indicator port on Baler Mounted Processor.	1. Switch ports.
System does not pause at the end of a row.	1. Short in cable.	1. Replace cable.
Bale rate displays zero.	1. Bale rate sensors are reversed. 2. Short in cable.	1. Switch the sensors next to the star wheel. 2. Replace cable.
Display will not power up.	1. Display connector plug and bale rate sensors plug are switched on the Baler Mounted Processor. 2. Short in display cable.	1. Switch plugs. 2. Replace cable.
Display is too dark or light	1. Change in temperature or light conditions.	1. Use the monitors contrast control.
	2. Display and BMP not communicating.	2. Disconnect 12 volt power cable at hitch. DO NOT DISCONNECT DISPLAY CABLE. Wait 5 minutes and reconnect.
Display says waiting for BMP	1. Display and BMP not communicating.	1. Disconnect 12 volt power cable at hitch. DO NOT DISCONNECT DISPLAY CABLE. Wait 5 minutes and reconnect.

BACKUP FUSE

The Model 462 is equipped with a backup system if your display is not functioning. This function is intended for use only as a temporary means for application and not as a way to apply preservative over multiple fields or for a lengthy amount of time. The baler mounted processor has a location for a backup fuse on the same side as the pump and flowmeter harness that bypasses all other system inputs and applies preservative using one pump (Pump Three) at a constant lbs/hour shown below. These values are based upon an input voltage of 13.5 DC. Insert at least a 10 amp up to 20 amp fuse (3 AG style) into the backup fuse port to activate the bypass. The system will not turn off or pause until the fuse is removed. The main fuse must also be functional for the backup fuse to work.

	Tip Set	Output (lbs/hour)
462	High	180
	Low	150

WIRING DIAGRAMS

A. Main power connector mounted on battery

Pin 1	Red	+ 12 V input from tractor supply
Pin 2	Black	Ground from tractor supply
Pin 3	Not used	



B. Main power connector mounted on BMP

Pin 1	Red	+ 12 V input from tractor supply
Pin 2	Black	Ground from tractor supply
Pin 3	Not used	

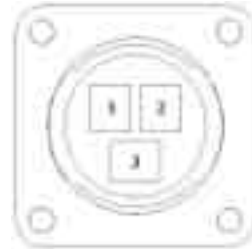

C. Pump connection colors

Pin 1	Black with orange markings	Pump 1 ground
Pin 2	Black with green markings	Pump 2 ground
Pin 3	Black with yellow markings	Pump 3 ground
Pin 4	Not used	
Pin 5	Orange with black markings	Pump 1 positive
Pin 6	Green with black markings	Pump 2 positive
Pin 7	Yellow with black markings	Pump 3 positive

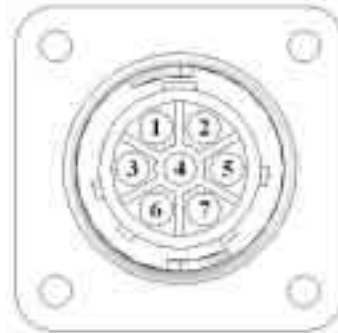

D. Flow meter connection on BMP

Pin 1	White	5 - 12 V (+) supply
Pin 2	Green	Ground
Pin 3	Brown	Signal
Pin 4	Black	Shield



E. Connector for Hay Indicator option on BMP

Note: Hay indicators are an option that will turn the system on and off automatically as hay enters the pickup of the baler.

Pin 1	Red	+12V
Pin 2	Black	Ground
Pin 3	White	Signal wire
Pin 4	Not used	

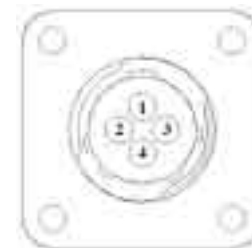

F. Bale rate sensors on BMP

Pin1	Brown	Sensor power
Pin2	Black	Signal for front prox. sensor
Pin3	Blue	Sensor ground
Pin4	Black	Signal for back prox. sensor



G. Star wheel connector mounted on BMP

Pin 1	Brown	Star wheel input 1
Pin 2	Blue	Star wheel input 2
Pin 3	Brown	Diagnostic 1
Pin 4	Blue	Diagnostic 2
Pin 5	Silver	Shield
Pin 6	Silver	Shield
Pin 7	Not used	
Pin 8	Not used	
Pin 9	Not used	



H. Communication harness display to hitch

Pin 1	Red	Power to display
Pin 2	Black	Ground to display
Pin 3	Blue	Comm channel OH
Pin 4	Orange	Comm channel OL

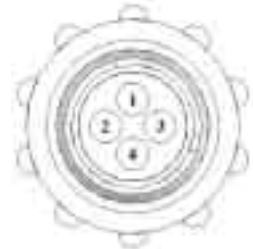

I. Communication harness hitch to baler mounted processor

Pin 1	Red	Power to display
Pin 2	Black	Ground to display
Pin 3	Blue	Comm channel OH
Pin 4	Orange	Comm channel OL



HARVEST TEC MODEL 445 BASE KIT

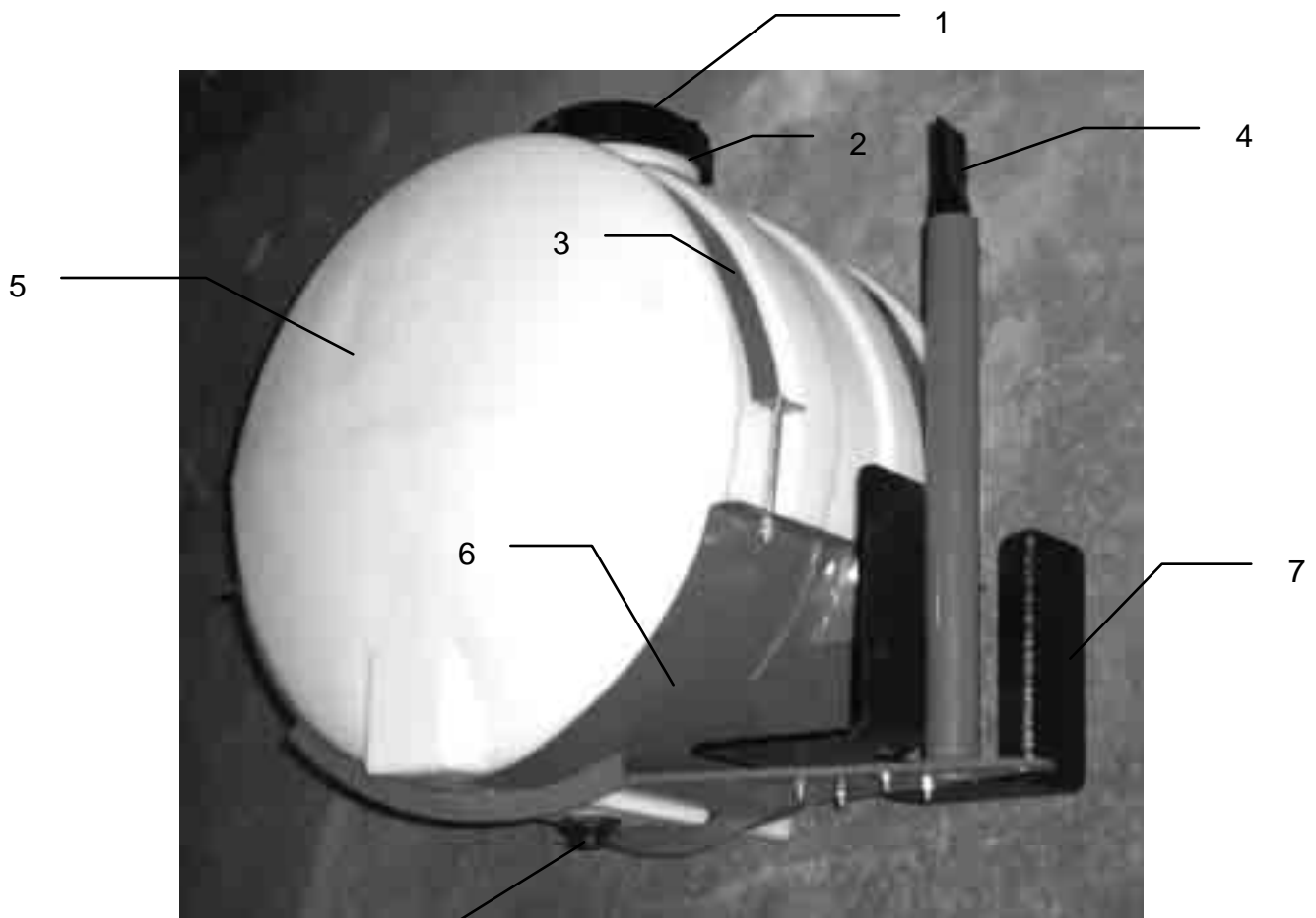

<u>Ref#</u>	<u>Description</u>	<u>Part #</u>	<u>Qty</u>
1	Tank Cap	005-9022C	1
2	Tank Cap Gasket	005-9022CG	1
3	Tank Strap	001-4402	2
4	Stub Pipe	001-4403	1
5	Tank	005-9022	1
6	Saddle	001-4401	1
7	Mounting Bracket	001-4647	1
8	Tank Fitting	005-9100	1

PARTS BREAKDOWN FOR PUMP PLATE

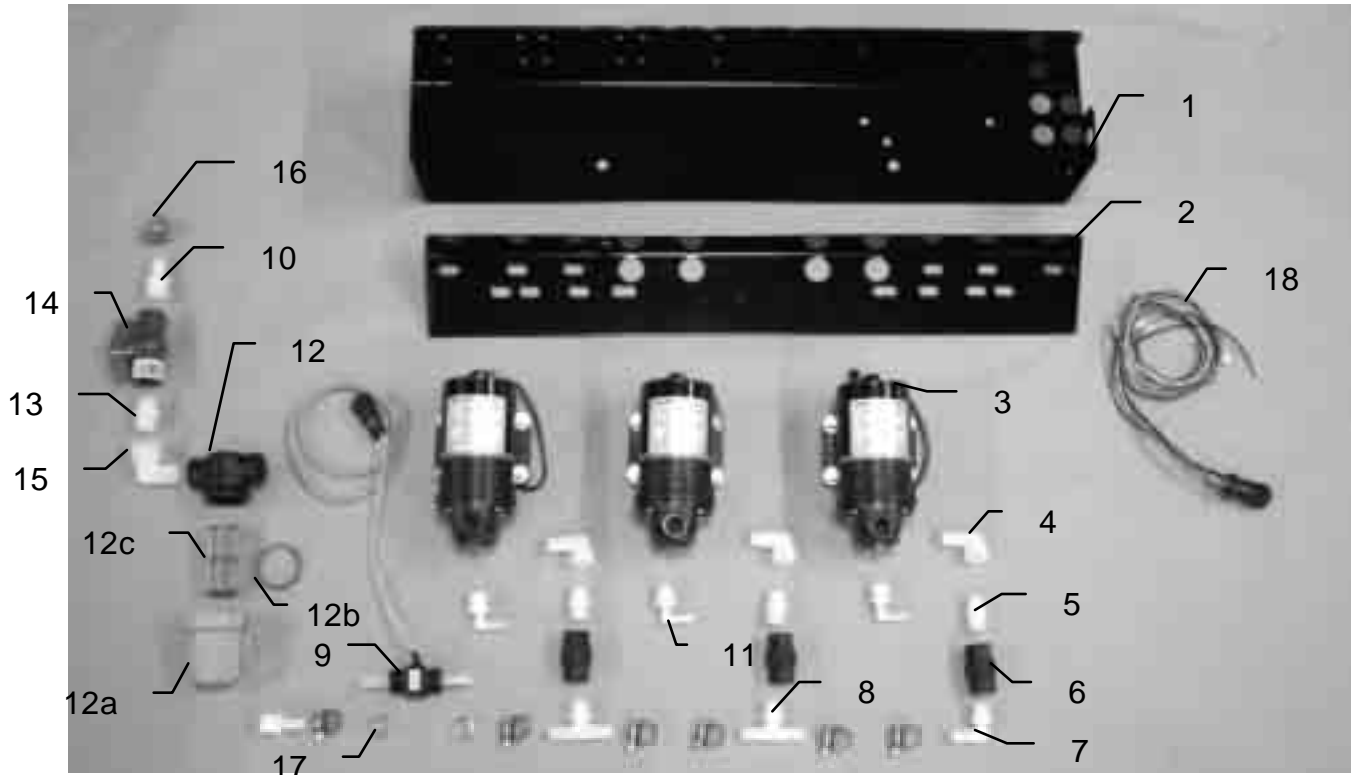

<u>Ref#</u>	<u>Description</u>	<u>Part#</u>	<u>Qty</u>
1	Pump plate	001-4646D	1
2	Mounting Bracket	001-4646C	1
3	Pump	007-4120H	3
4	Street elbow fitting	003-SE38	3
5	Nipple fitting	003-M3838	3
6	Check valve	002-4566F	3
7	Elbow fitting	003-EL3812	1
8	Tee fitting	003-T3812HB	2
9	Flow meter assembly	006-4725A	1
10	Straight fitting	003-A1212	2
11	Elbow fitting	003-EL3814	3
12	Filter bowl assembly	002-4315	1
12a	Filter bowl only	002-4315F	1
12b	Filter bowl gasket	002-4315D	1
12c	Filter bowl screen	002-4315B	1
13	Nipple fitting	003-M1212	1
14	Ball valve	002-2212	1
15	Street elbow fitting	003-SE12	1
16	Hose clamp	003-9003	7
17	Hose clamp (Flow Meter)	003-9005	2
18	Pump Cable	006-4660Z	1
NP	Pump rebuild kit (1 per pump)	007-4581	1
NP	Not Pictured		

PARTS BREAKDOWN FOR STAR WHEEL SENSOR, BALE RATE SENSOR, AND HOSES

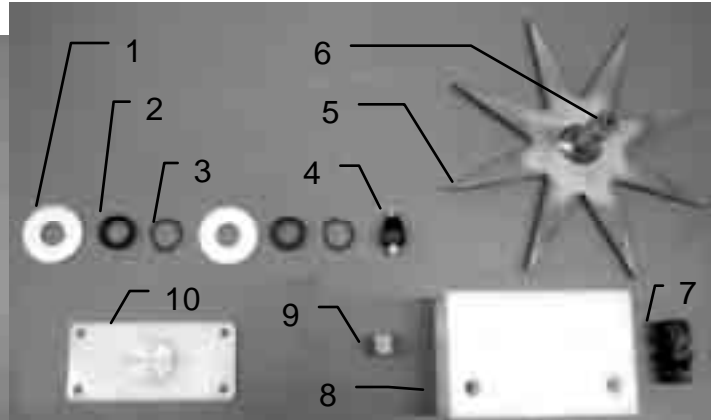
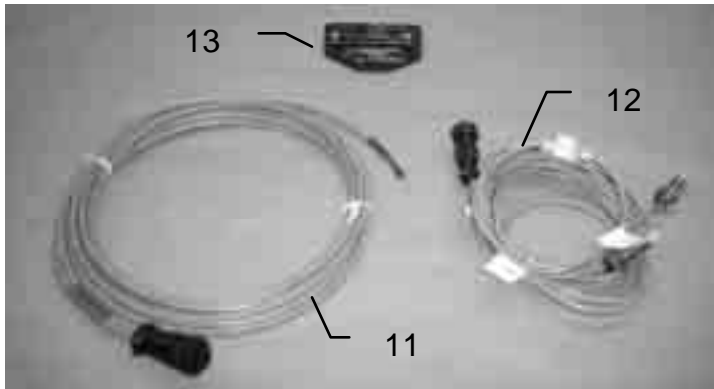

<u>Ref</u>	<u>Description</u>	<u>Part#</u>	<u>Qty</u>	<u>Ref</u>	<u>Description</u>	<u>Part#</u>	<u>Qty</u>
1	Washer		4	8	Star wheel block	006-4641A	2
2	Dust Seal		4	9	Plug Fitting	003-F38	2
3	Snap Ring		4	10	Block Cover	006-4641B	2
4	Swivel	006-4642A	2	11	Moisture cable	006-4640D	1
5	Star Wheel	006-4641C	2	12	Bale rate sensors	006-7202	1
6	Insert	006-4642B	2	13	Prox holder	001-4644SS	1
7	Wiring grommet	008-0821A	2	1-10	Star wheel assembly	030-4642	2

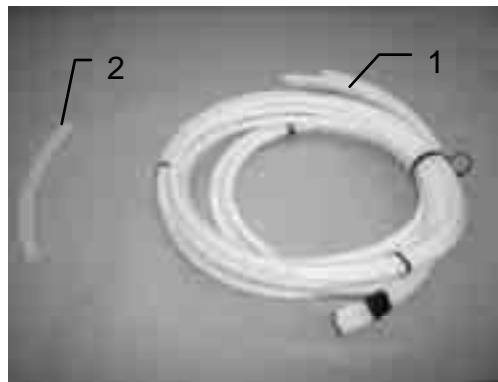

<u>Ref</u>	<u>Description</u>	<u>Part#</u>	<u>Qty</u>
1	Triple weld hose (from pumps to tips)	002-9016	15ft
		002-9016B	15ft
		002-9016G	15ft
	Hose assembly (3 hose assembly)	030-9016SS	1
2	1/2" Hose (tank to filter)	002-9001	6ft

PARTS BREAKDOWN FOR CONTROL BOX AND WIRING HARNESSES

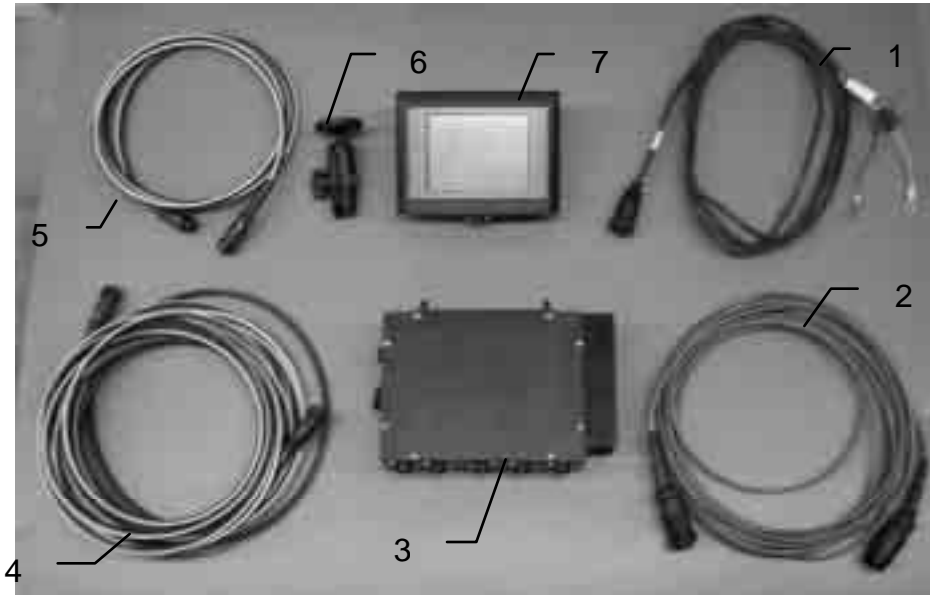

<u>Ref</u>	<u>Description</u>	<u>Part#</u>
1	Power lead tractor	006-4640A
2	Power lead baler	006-4660K
3	Baler mounted processor	006-4671SS
4	Communication harness (baler)	006-4660L
5	Communication harness (tractor)	006-4660N
6	Ram mount	001-2012H
7	465 Terminal	006-4670

HARVEST TEC MODEL 4409B INSTALLATION KIT FOR UNIVERSAL CONVENTIONAL SQUARE BALERS, AUTOMATIC CONTROL

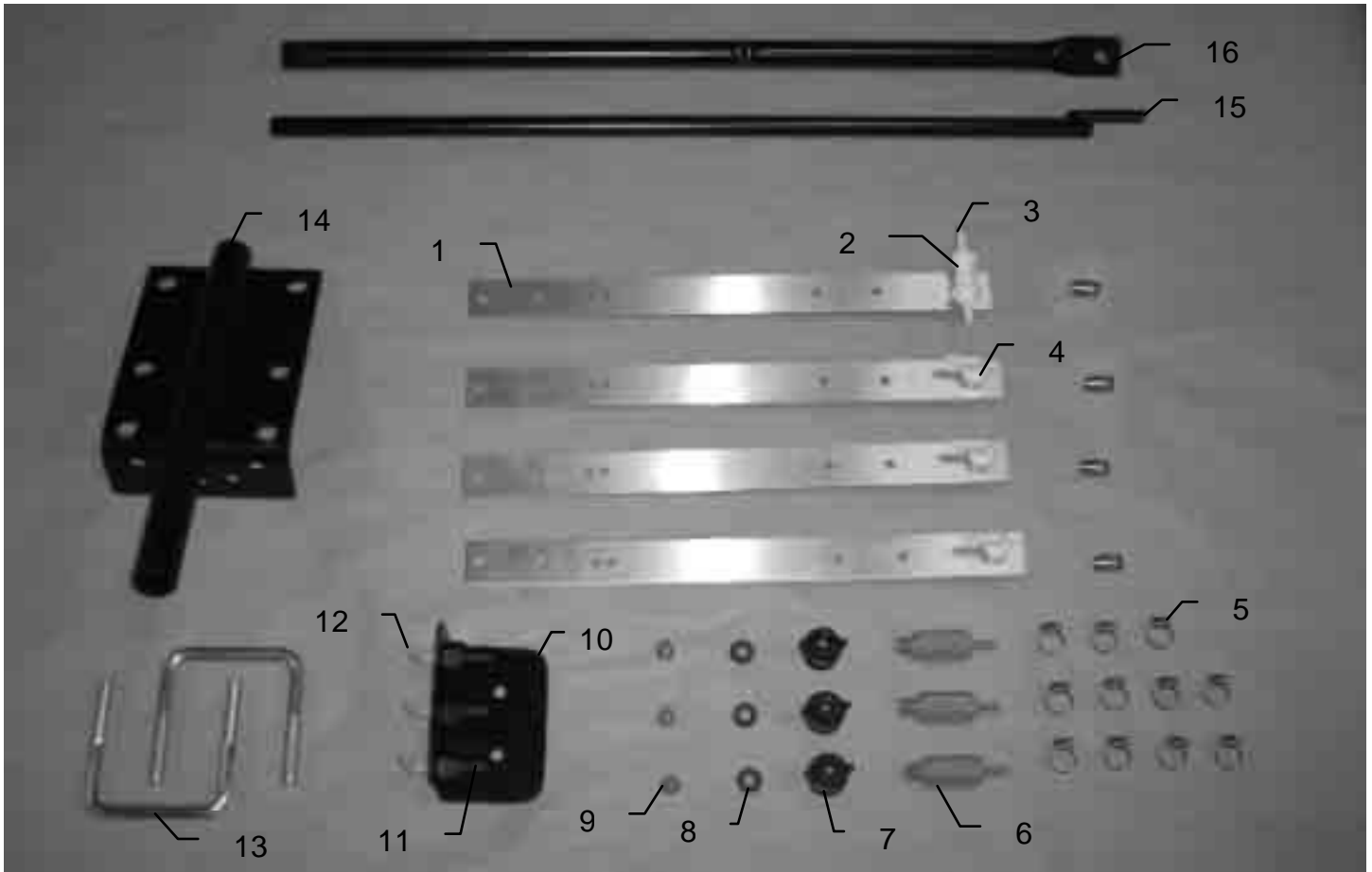

<u>Ref</u>	<u>Description</u>	<u>Part#</u>	<u>Qty</u>	<u>Description</u>	<u>Part#</u>	<u>Qty</u>
1	Nozzle strap	001-4215	4	Tip	004-T650033-SS	2
2	Tee	003-TT14SQ	1	Tip	004-T110015-SS	1
3	Straight fitting	003-A1414	2	Tip	004-T11003-SS	1
4	Elbow	003-EL1414F	3	Hose	002-9016	9 ft
5	Hose clamp	003-9002	11			
6	Check valve	002-4564XB	3			
7	Female disconnect	004-1207H	3			
8	Washer	004-1207W	3			
9	Tip screen	004-1203-200	3			
10	Hose bracket	001-4720	1			
11	Female coupler	004-1207G	3			
12	Elbow	003-EL1414	3			
13	U bolt	001-4406A	2			
14	Mounting bracket	001-4406	1			
15	Inside reach rod	001-4405	1			
16	Outside reach rod	001-4404	1			

HARVEST TEC MODEL 4410B INSTALLATION KIT FOR JOHN DEERE CONVENTIONAL SQUARE, AUTOMATIC CONTROL

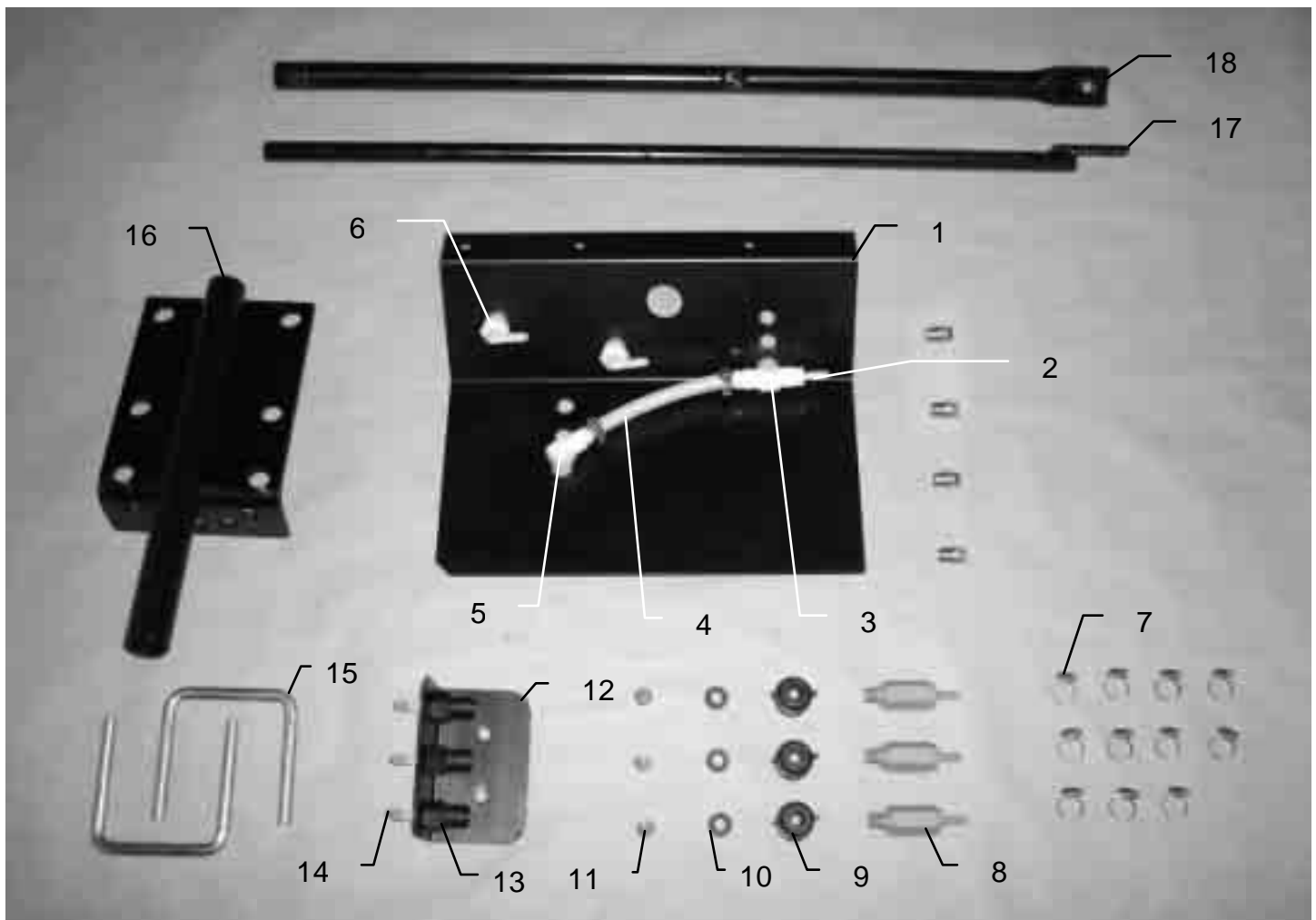

<u>Ref</u>	<u>Description</u>	<u>Part#</u>	<u>Qty</u>	<u>Description</u>	<u>Part#</u>	<u>Qty</u>
1	Spray shield	001-4426	1	Tip	004-T650033-SS	2
2	Straight fitting	003-A1414	3	Tip	004-T110015-SS	1
3	Tee	003-TT14SQ	1	Tip	004-T11003-SS	1
4	Hose	002-9016	9 ft			
5	Elbow	003-SE14F	1			
6	Elbow	003-EL1414F	2			
7	Hose clamp	003-9002	11			
8	Check valve	002-4564XB	3			
9	Female disconnect	004-1207H	3			
10	Washer	004-1207W	3			
11	Tip strainer	004-1203-200	3			
12	Hose bracket	001-4720	1			
13	Female coupler	004-1207G	3			
14	Elbow	003-EL1414	3			
15	U bolt	001-4406A	2			
16	Mounting bracket	001-4406	1			
17	Inside reach rod	001-4405	1			
18	Outside reach rod	001-4404	1			

HARVEST TEC MODEL 4412B INSTALLATION KIT FOR CLAAS, INTERNATIONAL, MASSEY, & WELGER CONVENTIONAL SQUARE BALERS, AUTOMATIC CONTROL

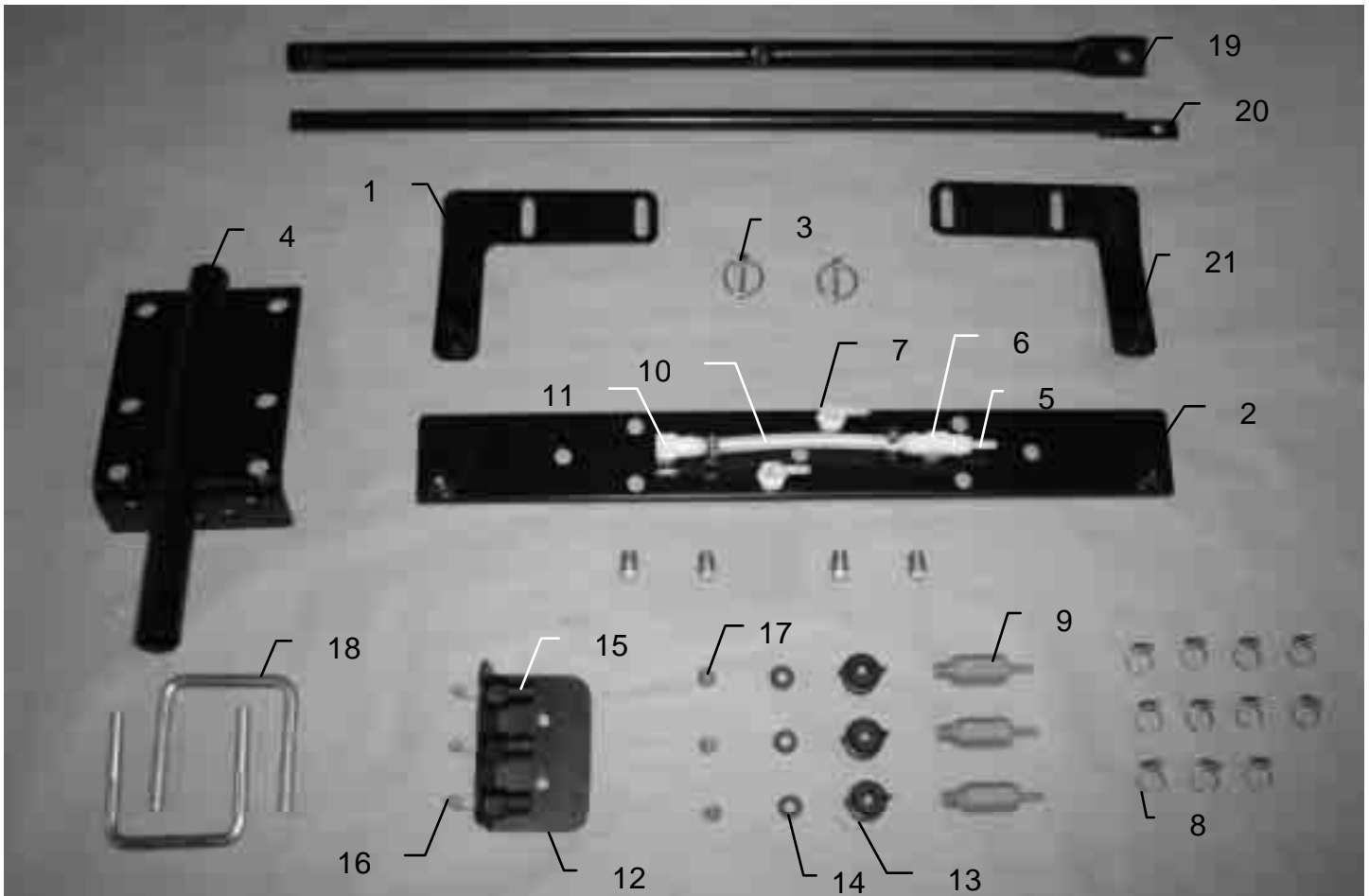

<u>Ref</u>	<u>Description</u>	<u>Part#</u>	<u>Qty</u>	<u>Description</u>	<u>Part#</u>	<u>Qty</u>
1	Shield holder	001-4436DL	1	Tip	004-T650033-SS	2
2	Spray shield	001-4810	1	Tip	004-T110015-SS	1
3	Lynch pin	008-4576	2	Tip	004-T11003-SS	1
4	Mounting bracket	001-4406	1			
5	Straight fitting	003-A1414	3			
6	Tee	003-TT14SQ	1			
7	Elbow	003-EL1414F	2			
8	Hose clamp	002-9002	11			
9	Check valve	002-4564XB	3			
10	Hose	002-9016	1			
11	Elbow	003-SE14F	1			
12	Hose bracket	001-4720	1			
13	Female disconnect	004-1207H	3			
14	Washer	004-1207W	3			
15	Female coupler	004-1207G	3			
16	Elbow	003-EL1414	3			
17	Tip strainer	004-1203-200	3			
18	U bolt	001-4406A	2			
19	Outside reach rod	001-4404	1			
20	Inside reach rod	001-4405	1			
21	Shield holder	001-4436DR	1			

HARVEST TEC MODEL 4415B INSTALLATION KIT FOR NEW HOLLAND 570 – 580 AND CASE SBX 530-550 SMALL SQUARE BALERS

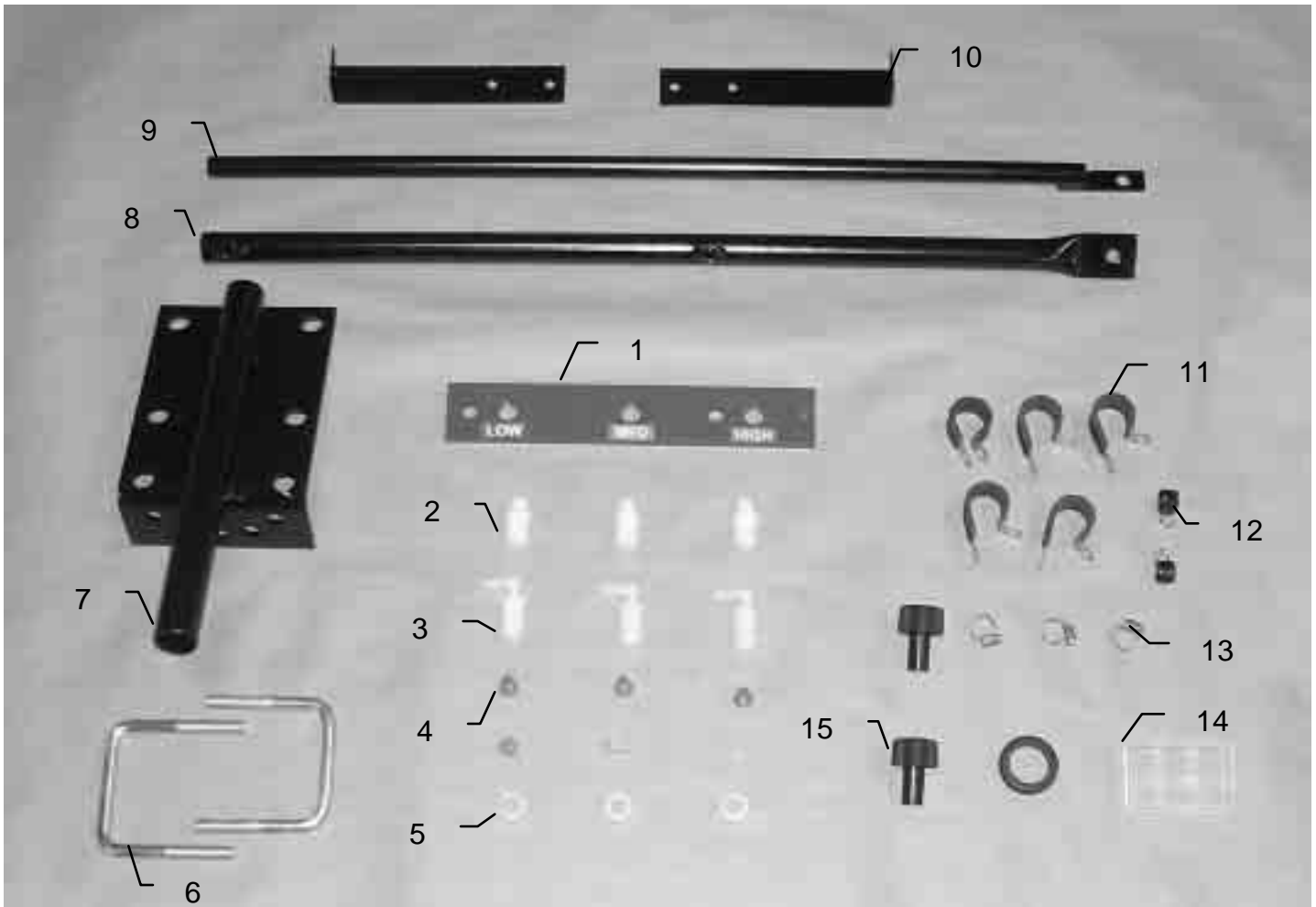

<u>Ref</u>	<u>Description</u>	<u>Part#</u>	<u>Qty</u>	<u>Description</u>	<u>Part#</u>	<u>Qty</u>
1	Spray shield	001-4425C	1	Tip	004-30HCX4	1
2	Drill guide	003-M3814NB	3	Tip	004-30HCX9	1
3	Elbow	003-EL3814NB	3	Tip	004-30HCX18	1
4	Tip strainer	004-4213-100	3			
5	Nozzle cap	004-BC12	3			
6	U bolt	001-4406A	2			
7	Mounting bracket	001-4406	1			
8	Outside reach rod	001-4404	1			
9	Inside reach rod	001-4405	1			
10	Hose bracket	001-4425B	2			
11	Jiffy clip	008-9010	5			
12	Jiffy clip	008-9014	2			
13	Hose clamp	003-9003	3			
14	Tip box	008-9001	1			
15	Knob	008-0925	2			

NOTES:

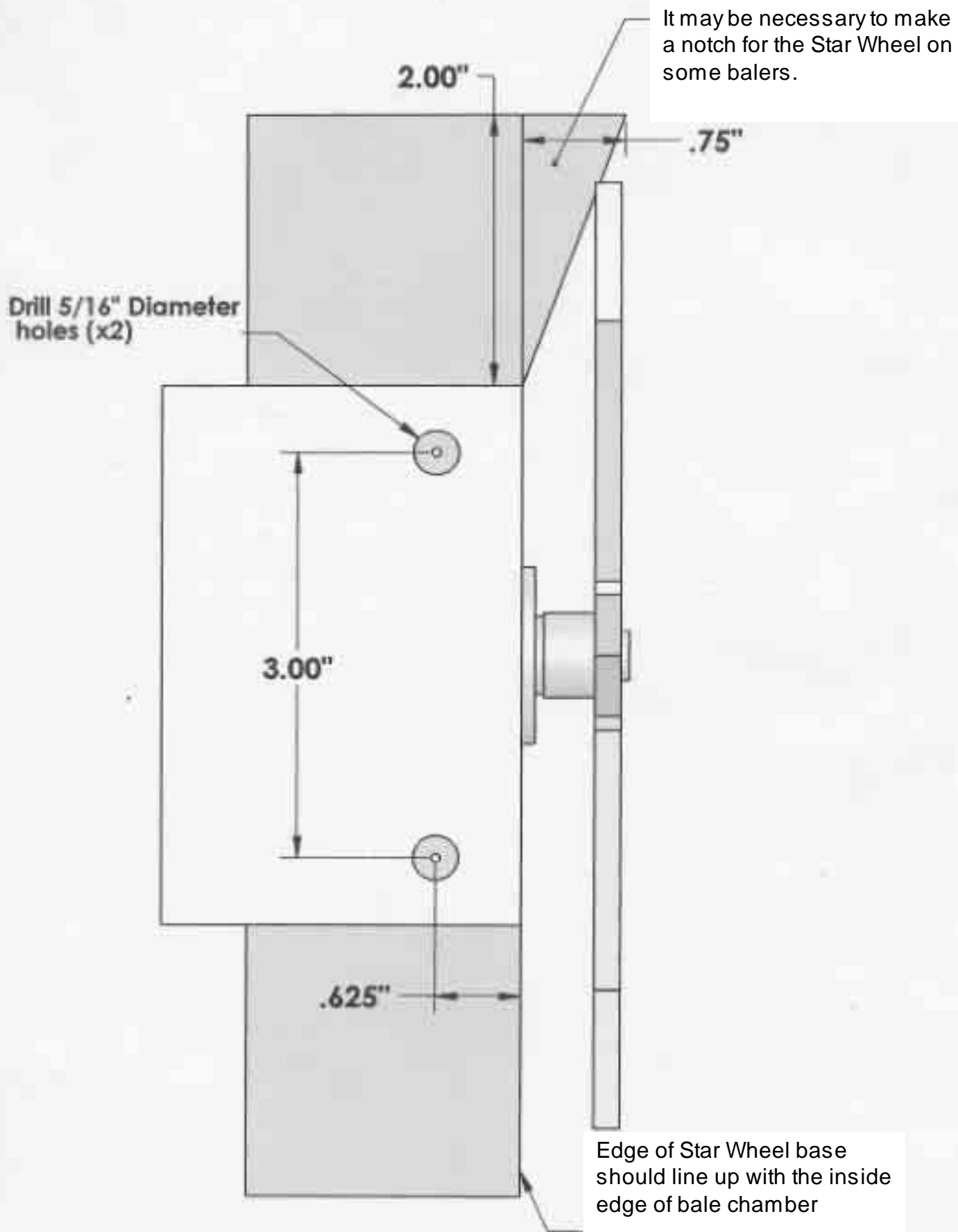

4415B Spray shield template

← KNIFE

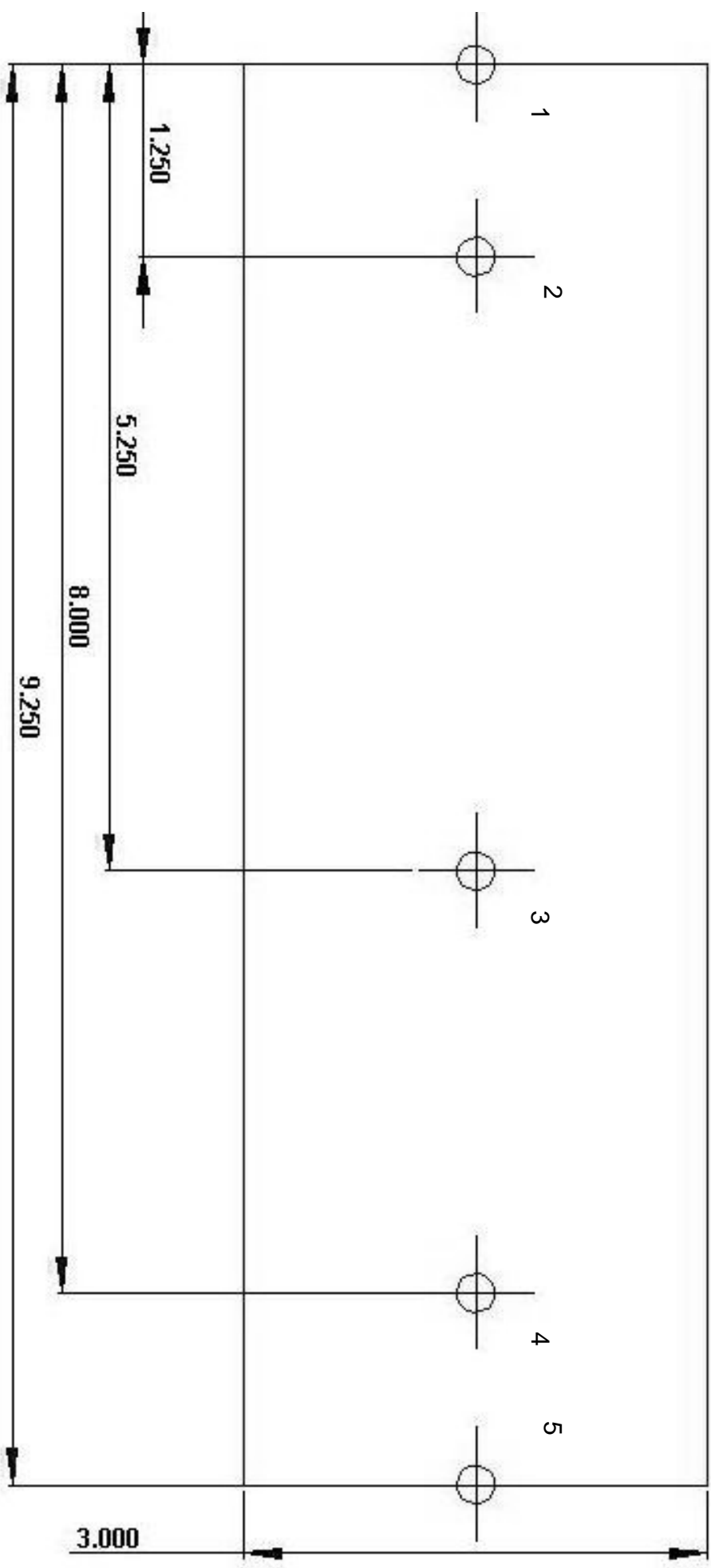

WARRANTY AND LIABILITY AGREEMENT

Harvest Tec, Inc. will repair or replace components that are found to be defective within 12 months from the date of manufacture. Under no circumstances does this warranty cover any components which in the opinion of Harvest Tec, Inc. have been subjected to negligent use, misuse, alteration, accident, or if repairs have been made with parts other than those manufactured and obtainable from Harvest Tec, Inc.

Our obligation under this warranty is limited to repairing or replacing free of charge to the original purchaser any part that in our judgment shows evidence of defective or improper workmanship, provided the part is returned to Harvest Tec, Inc. within 30 days of the failure. Parts must be returned through the selling dealer and distributor, transportation charges prepaid.

This warranty shall not be interpreted to render Harvest Tec, Inc. liable for injury or damages of any kind, direct, consequential, or contingent, to persons or property. Furthermore, this warranty does not extend to loss of crop, losses caused by delays or any expense prospective profits or for any other reason. Harvest Tec, Inc. shall not be liable for any recovery greater in amount than the cost or repair of defects in workmanship.

There are no warranties, either expressed or implied, of merchantability or fitness for particular purpose intended or fitness for any other reason.

This warranty cannot guarantee that existing conditions beyond the control of Harvest Tec, Inc. will not affect our ability to obtain materials or manufacture necessary replacement parts.

Harvest Tec, Inc. reserves the right to make design changes, improve design, or change specifications, at any time without any contingent obligation to purchasers of machines and parts previously sold.

Revised 01/03/06

HARVEST TEC, INC.
P.O. BOX 63
2821 HARVEY STREET
HUDSON, WI 54016
PHONE: 715-386-9100
1-800-635-7468
FAX: 715-381-1792
Email: info@harvesttec.com